

SHIMANO

PLAYS 3000

Thank you for purchasing a Shimano PLAYS 3000.

Before using this reel, please make sure you read the manual thoroughly and keep it in a safe place for future reference.

Safety Precautions	2	S A-RB	49
Features	8	Automatic Gunwale Stop	50
Digital Display Component Names	10	Alarm (Gunwale Stop Position)	52
Functions with Settings that Can Be Changed from the Menu	12	Programming Target Depth and Bottom Depth	53
Part Names	16	Alarm (Depth)	54
Power Supply Cord	17	Finding the Target Depth	55
Learning Methods	18	Top-Down Mode Example	56
Learning Mode	19	Bottom-Up Mode Example	57
Learning Methods (Inputting the actual value of the line use into the reel.)		Program Mode	58
Braided Line Learning (E1)	20	Jigging Learning	60
Mono Line learning (E2)	22	Using the Program Mode	63
Backing Line Learning (E3)	24	Rig Retrieval Time	66
Backing Line Learning (E3)	28	Spool Free Mode	67
Backing Line Learning (L1)	32	Line Learning Adjustment	69
Backing Line Learning (L2)	34	Handling Instructions	72
Backing Line Learning (L2)	38	Specifications	78
Pull-out Line Learning (P1)	42	Troubleshooting	79
Various Techniques	45	Product Inquiries / After Sales Service Information	81
Zero Setting	46	Service network	82
Adjusting Smart Line Depth	48		

Safety Precautions

Please read these safety precautions before using the reel.



Warning



Caution: High Temperature

- Use only the specified voltage (DC12~16.8V) from a battery or the vessel's onboard power supply. Using voltages other than those specified may cause the reel to heat up, damage electrical components or burn your hand.
- Never connect the reel to a household power supply or a battery charger. Doing so may damage the circuit boards and cause fire and smoke.
- Stop using the reel immediately if the power supply connector or alligator clips become abnormally hot.

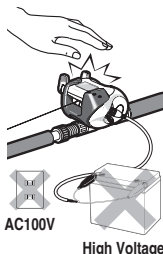

Warning

- Do not use lithium-ion batteries not manufactured by Shimano. Shimano is not liable for any accidents or damage caused by use of Li-ion batteries not manufactured by Shimano.
- * There are countries and regions where Shimano-manufactured Li-ion batteries are not available.



Do not get your fingers caught!

- To avoid injury, please do not touch the line while it is being fed out or wound in.

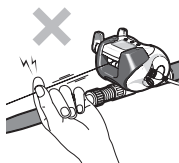

Warning



Warning

- If the circuit breaker in the reel is tripped repeatedly, it is possible that the specifications of the reel are not appropriate for the load from that particular species of fish or rig. If you continue to use the reel in such a situation, the motor or display may overheat and be damaged. In that case, please change to a higher performance reel.



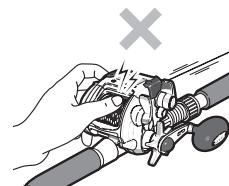

Caution: Rotating Objects

- Do not put your finger near rotating parts such as the spool as this can injure your finger.



Warning

- Please do not use the reel with a vessel's power supply or a battery that does not provide the proper voltage. When the battery mark ( or ) lights up and starts flashing, winding in under heavy load (high current) may damage the electronic components in the display and cause the lens to pop out.

Warning



Don't get your finger caught!

- Do not put your finger near the level winding position when fishing as it may get caught and cause injury. If your finger does become caught, turn off the power switch on the reel immediately and disassemble the reel.
- Do not put your finger in between the handle and the body as it may get caught and cause injury.

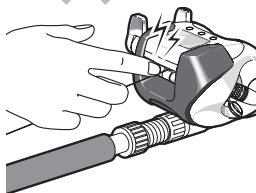

Warning

- A very weak electrical signal is produced when using the reel. This may cause medical equipment such as hearing aids and pacemakers to malfunction, causing the user to have palpitations or become dizzy.

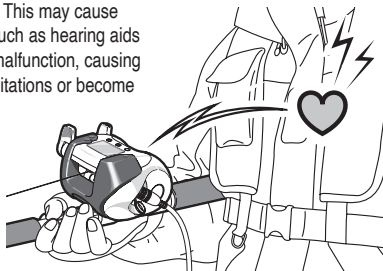

Warning



Warning

- Immediately remove the power cable if you see moisture or water droplets on the inside of the display. If you continue to use the reel in such a situation it may malfunction, break the tip of the rod and cause injury.
- Stop using the reel if you see a crack develop in the display or the case. If water penetrates into the case it can cause shorting to occur, which can damage the electronics and make it impossible to control the motor.

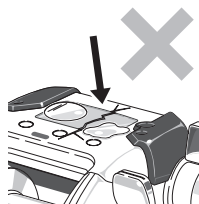

Warning

- Stop using the reel immediately if a burning smell or smoke is emitted from the reel or the display, or if the reel becomes abnormally hot. If you continue to use the reel in this situation then the reel may catch fire.
- Disconnect the power connector or the alligator clips from the battery immediately if the motor cannot be stopped.

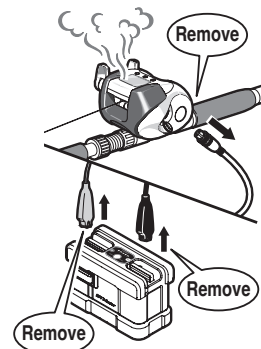

Caution



Caution

- When using the reel, if the display goes off, do not wind the line in manually using the handle as this will mean there will be a difference between the actual line length and the counter. If you do wind the line in manually using the handle, after the display comes back on and you start winding the line in again using the motor the gunwale stop position will be incorrect, which can cause the rig to be wound in too much and even snap off the end of the rod. Therefore, it is important to investigate why the display has gone off and fix the problem and to only wind in the line after the display comes back on.

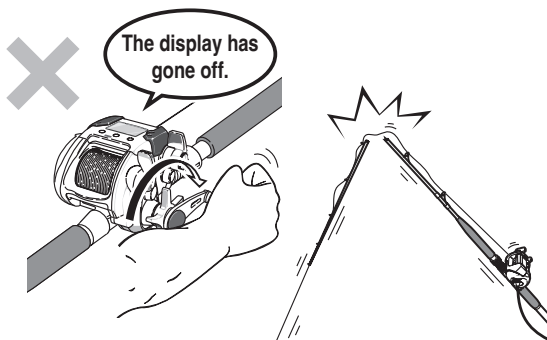

Caution



Caution

- If the surface of the coating on the reel comes off or if the surface of the material comes off due to a strong impact leaving a sharp edge, do not touch that area as it may cause injury.



Caution

- If the battery mark (**B** or ) lights up and starts flashing, this means that battery voltage is dropping, which will lead to a decrease in performance. It also means that excessive load is being placed on the motor and display, which may cause the reel to malfunction. Stop using the reel immediately and connect to a fully charged battery.



Caution: Rotating Objects

- To avoid injury, please do not touch the rotating spool.

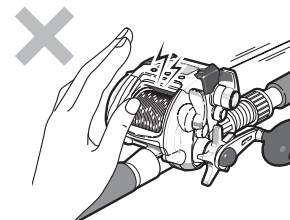



Caution



Caution

- Please secure the reel to the rod.
Do not use the reel if it is cross-threaded or not properly secured as it may come off during fishing and cause injury.

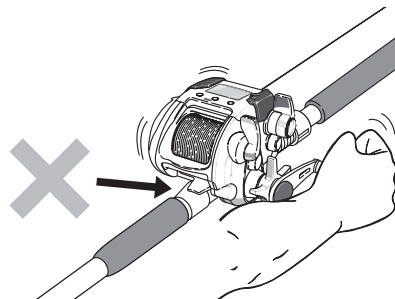

Caution



Caution

- Please proceed with caution when using the reel around children.
- Please store the reel out of the reach of children.

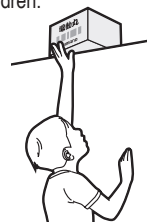

Caution

- The reel may malfunction if it is dropped and the display damaged due to the impact. Please take care to avoid any such impacts.

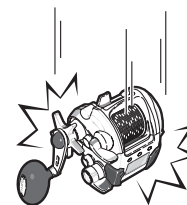

Caution

- Do not wrap the cable around your body as depending on how the fish is pulled in it may cause you to be thrown into the sea.

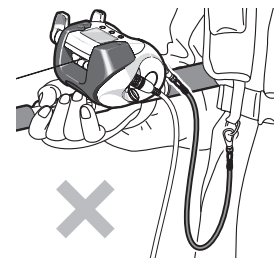



Caution



Caution

- Always remove the cable from the battery when carrying out maintenance on the reel when it is in use as the spool may move at any time causing injury to the user or damage to the reel.

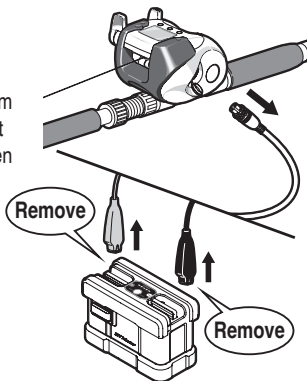

Caution

- Always decrease drag before connecting the power supply. There is the possibility that the rod may be damaged if the motor malfunctions, cannot be stopped and retrieves the rig.

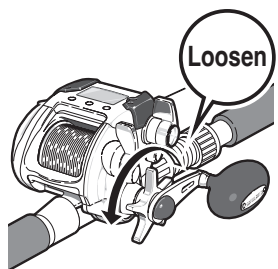

Caution



Do NOT Disassemble

- Please do not modify the reel as this can cause performance to deteriorate and safety features to malfunction.
- Please do not modify the cable as this may cause performance to deteriorate, generate heat or result in a fire.

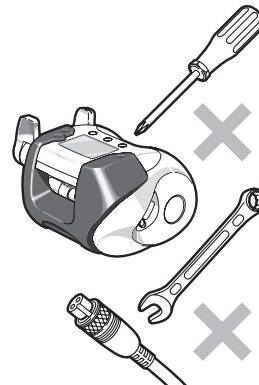

Caution

- The gunwale stop position may change according to factors such as retrieval tension. If the gunwale stop position changes, please reset the counter to zero again. This is just in case the gunwale stop position changes, which can break the tip of the rod.

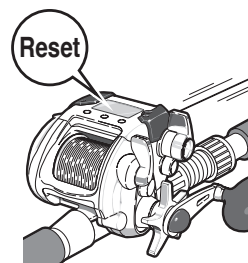



Caution



Caution

- Please do not touch the metal parts of the alligator clips, the terminals of the battery, or power supply with wet hands as there is the danger of electric shock.

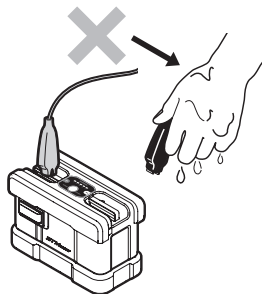

Caution

- Check that the terminals are not wet before attaching the power cord to the reel. If the terminals are wet this can cause a short circuit, which may result in fire or smoke that can lead to injury.

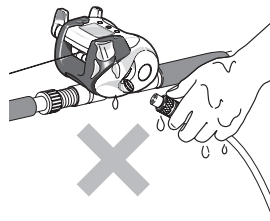

Caution

- When the line is caught, do not exert excessive force on the rod or reel. Instead, please cut the line after taking care to minimize the amount of line left in the fishing ground.



Caution



Caution

- Do not try to dry the reel using a hair dryer or some other heating appliance after carrying out maintenance as this may deform the resin.

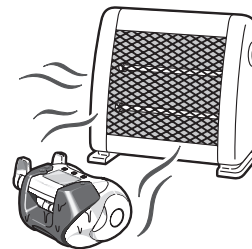

Caution: Motor Malfunction

- The display is water-resistant to a depth of 10m. However, if the reel is dropped or receives an impact of some kind and the display is damaged or cracked, the motor may malfunction if water is able to penetrate into the reel. As injury may occur if the motor malfunctions and suddenly retrieves the line, etc., if the display is cracked or damaged, immediately remove the power cord, stop using the reel and return it to the place of purchase. If there is no licensed Shimano dealer nearby, please enquire as to the location of your nearest service center.
- This reel operates on DC12~14.8V. Using a higher voltage or a household power supply may damage the electronic circuits in the display and make it impossible to control the motor. As this could also result in smoke or fire, always check the specification of the power supply before use.

Features



To pick up line slack or for controlling motion patterns
Pick up P22, 27
 The motor winds in the line for as long as the button is pressed.



Estimated measurement of bait spreading and rig retrieval timing
Top-Down timer P22
 Displays the elapsed time after the rig reaches the target depth from the surface.



Prevents rig from winding up into tip and alerts you to a strike
Spool Free Mode P22, 28, 86~87
 Spool Free Mode enables two functions—the Overwinding Prevention Function and the Strike Detection Alarm.



Rust and Corrosion-Resistant Bearings
Shielded Antirust Bearings P62
 A special corrosion-resistant material is applied to the surface of conventional antirust bearings to minimize saltwater penetration. These bearings are located at strategic locations to achieve even smoother performance. Not only are these bearings resistant to rust, but they also minimize the formation of salt crystals inside the bearings, which can lead to corrosion.



Lightweight, compact design
 that is among the best in its class.



Even better-developed...
High speed & high power functions



Drop your rig to precisely the desired depth time and again...
0 (zero) Set P22, 24, 57~59
 You can reset the depth to 0 meters when the rig is at the water's surface. This will let you hit the desired depth with greater precision.



Stops retrieving the line at the point where you can raise the rod vertical and have the rig come straight to your hand. P63~64
 The gunwale stop position is set automatically, allowing you to raise the rod vertical and have the rig come straight to your hand.



Displays the time remaining for the rig to be retrieved. P85
 Displays the time remaining for the rig to be retrieved to the gunwale using the motor.



Allows you to easily return your rig to the same depth after repairing your line if it breaks. P60~61
 If you break your line, after repairing it, lower the rig to the surface and press 0 Set. The Smart Line Depth function then automatically returns your rig to the same depth it was at before it broke.



The Technical Lever P22, 24, 30, 75
is used to adjust retrieval speed and Rakuraku settings.



Correct any discrepancy between the display and the length of line used.
Line Learning Adjustment P28, 67~69



Saved water depth displayed in the Saved Depth column
Saved depth P22, 70
Saves and displays the distance to shelf or bottom. In Bottom-Up Mode, the difference from the saved depth is displayed in the saved depth column.



Select the method of displaying the saved depth.
Switching between “Top-Down mode” and “Bottom-Up mode” P27, 72~74
This allows you to change the saved depth display mode when you want to check the distance from the bottom depending on fishing spot, fishing style or target fish. Top-Down Mode displays the saved depth, while Bottom-Up Mode displays the distance from the bottom to the saved depth.



Convenient for checking before fishing, and in the event the line breaks...
Line remaining display P28, 58~61, 68
Makes it possible to check the current length of line wound on the reel.



Drop your rig quickly
the Auto Dropping function P12, 45



Replicates pro-angler reeling patterns or your own programmed technique
Program Mode Replay program pattern P22, 27, 77~84

The electric reel can reproduce various movement patterns. Three movement patterns are available—3 Step, 2 Step, and Repeat—plus a Learning Mode to program/select your own movement patterns.

When the following symbols appear in this manual :

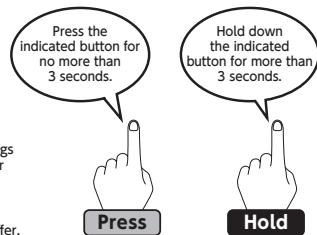

Note :
The values and settings shown on the counter illustrations in this manual are in some cases just examples. Actual values may differ.

Digital Display Component Names

Technical Lever Settings

Displays the winding speed (in 31 steps).

Top-Down timer

Displays the elapsed time after the rig reaches the target depth from the surface.

* Times from 0 to 59 seconds are displayed in units of 1 second, and from 1 to 99 minutes in units of 1 minute. After 100 minutes, timer returns to 0 seconds.

Spool Free Mode

When in Spool Free Mode, the brackets disappear.

■PICK UP (Pick Up/Program Mode) Button



Press

When the Pick Up function is ON, the line will be wound in by motor for as long as the PICK UP button is pressed.

Winding speed can be adjusted from 0 to Hi. (The default setting is 15.)

* Turning the Pick Up function ON automatically turns Program Mode OFF.
* After reaching the gunwale stop position, Pick Up is disabled.



Press

When Program Mode is ON, starts the Program Mode movement pattern.

This button can also be used to pause and re-start the movement pattern.

* Turning Program Mode ON automatically turns the Pick Up function OFF.
* After reaching the gunwale stop position, Program Mode is disabled.

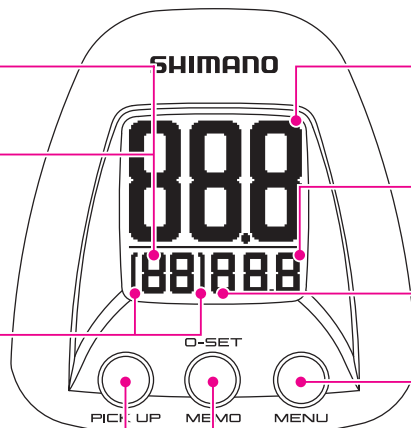

Present Depth

Displays depth from the surface of the water.

* Depth is shown in 10cm graduations.

Depths over 100m are shown in 1m graduations as shown below.

999 → 100

Low Charge Warning

If the charge is insufficient,  will flash.

Saved Depth

Top-Down Mode displays the saved depth, while Bottom-Up Mode displays the distance from the bottom to the saved depth.

* When Manual Mode is ON, "MANUAL" will be displayed.

■MENU Button



Hold

Display the Menu Screen. The settings of each function can be changed from the menu.

See the diagram at right for how to operate the Menu Screen.

■0-SET / MEMO Button



Hold

Zeroing the Counter

Lower the rig to the surface of the water and zero the counter.

* If you carry out zero setting when the depth display shows 10.1m or more, line breakage compensation will be carried out. Tie on a new rig, then lower it to the surface of the water before carrying out breakage compensation.



Press

Save depth information

The information displayed will differ depending on the selected mode.

* When Manual Mode is ON, the Saved Depth function is disabled.

When Electric Winding Load Display and Rig Retrieval Time are ON

As shown below, the status is shown under the **Current Depth** display.

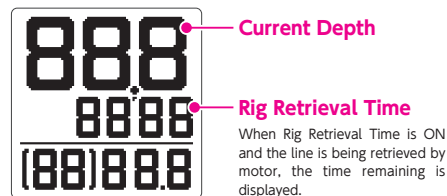

Basic Menu Screen Operation

Press and hold the MENU button for 3 seconds and you will hear two short beeps and the Menu Screen below will appear.

Menu Screen

Scroll through the list by moving the cursor up or down. For the list of functions with settings that can be changed from the Menu, see the next page of this manual.

Cursor

Highlights the menu item. Use the cursor to select the function.

Displays the functions of the buttons. Please use this as a guide for operation.

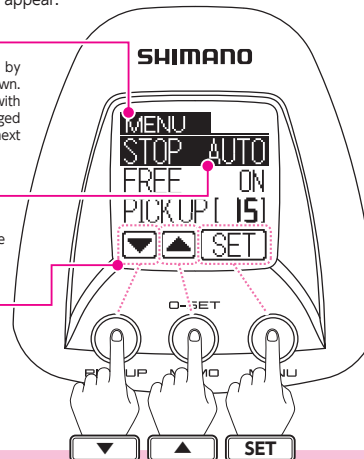

These buttons move the cursor up or down. When setting values, they are used to increase or decrease the value by 1.

Sets the function (or entered value) selected by the cursor.

Sets the function (or entered value) selected by the cursor.

If the motor or handle is used to wind up the line, the screen changes to the Water Depth Display from the Menu Screen.

See next page for a list of functions that can be set from the menu.

Functions with Settings that Can Be Changed from the Menu

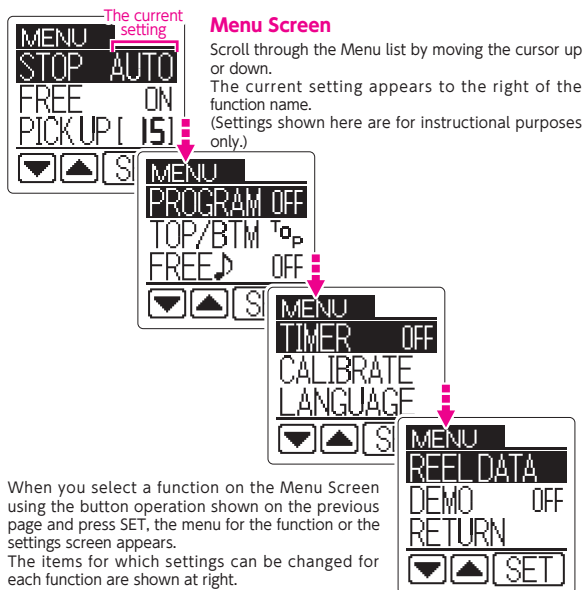

After each function is set, the screen will return to the Menu Screen.
To return to the Water Depth Display, select RETURN from the Menu Screen and press SET.

* When you change a setting from the default, the setting is saved even after the power is turned off.

STOP (Gunwale Stop Position)

This function can be set to either automatic or manual depth (1 to 6m).

* The initial setting is automatic.

→ See P50 ~ 51 for details.

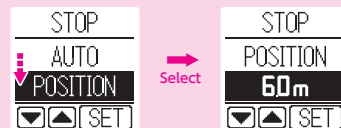

When you want to manually set the gunwale stop position

Use ▼▲ to set the desired gunwale stop position, and press SET.
(Increments of 10cm)

FREE (Auto Dropping Function)

This function can be turned ON or OFF.

With auto dropping, when lowering the rig, at 5m past the gunwale stop position, the motor starts automatically, minimizing spool resistance.
(Example : If the gunwale stop position is 1m, the motor starts at 6m.)

→ See P45 for details.



PICK UP

This function can be turned ON or OFF.

When ON, the winding speed can be set from 1 to Hi.



Setting the Pick Up Speed

When set to ON, you can make adjustments from the Pick Up speed setting screen (above right).

Use ▼▲ to increase or decrease the value to the speed you want, and press SET.

* When Pick Up Mode is ON, Program Mode is automatically turned OFF.

→ See P10 for details.

PROGRAM

Select a pro-angler reeling pattern or your own programmed technique.

* When Program Mode is ON, Pick Up Mode is automatically turned off.

→ See P58 ~ 65 for details.

TOP/BTM (Top-Down/Bottom-Up)

Switch between Top-Down and Bottom-Up Modes.

→ See P55 ~ 57 for details.

FREE ♪ (Spool Free Mode)

Turn this function ON or OFF.

When set to ON, the Strike Detection Alarm speed can be set from 1 to Hi.

When Spool Free Mode is ON, two functions are enabled—the Overwinding Prevention Function and the Strike Detection Alarm.

※ After "Fluoro Learning Mode E2" for Line Learning is completed, Spool Free Mode turns ON automatically.

→ See P67~68 for details.

TIMER (Rig Retrieval Time)

Turn this function ON or OFF.

→ See P66 for details.

CALIBRATE (Line Learning Adjustment)

Adjust to eliminate the discrepancy between actual line markers and the water depth counter.

→ See P69 ~ 71 for details.

LANGUAGE

You can switch between Japanese, English, Chinese, and Korean.

REEL DATA

Check the reel data (line retrieval distance/time taken/line remaining).

* Note regarding line remaining display : When the counter has been reset to 0 while the Water Depth Display shows under ± 10 , the Line Learning function will not make any adjustments and the remaining line length will not be updated.

Continued on the next page. →

DEMO MODE

Demo Mode allows continuous motor operation. When turning Demo Mode ON, the Water Depth Display will appear as in the image below.

* Once the Demo Mode screen has been displayed as below, press the 0-SET button. The motor will then begin operation.



Press the MENU button

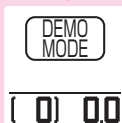

Note : Shimano takes no responsibility for any problems (such as a lure getting entangled with the rod tip) which may occur while Demo Mode is ON.

Returning to the Water Depth Display

After leaving the Menu Screen, the Water Depth Display will be shown again.

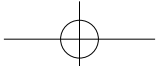
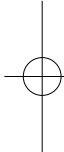
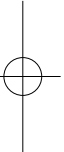
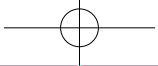

Part Names

Digital Counter

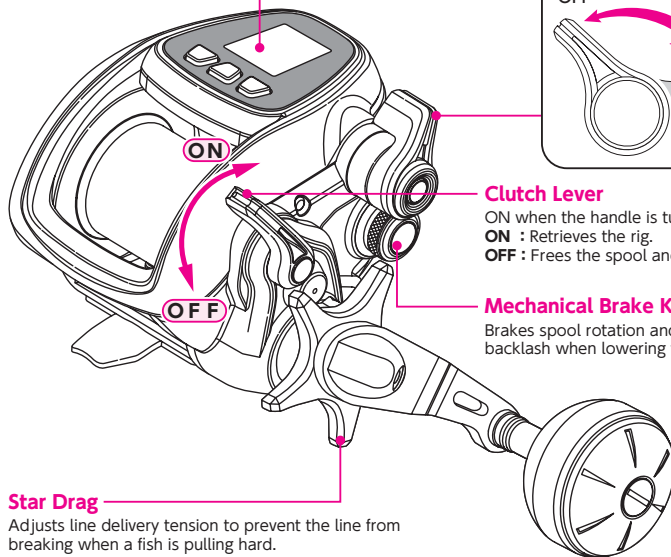

Star Drag

Adjusts line delivery tension to prevent the line from breaking when a fish is pulling hard.

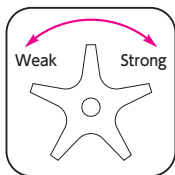

Safety Level Wind Cover

Power Cord Socket

* Always replace the connector cap when not using the reel.

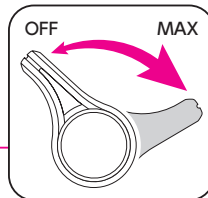

Technical Lever

Instantly adjusts the winding speed. After gunwale stop, if you want to restart the motor, then turn the lever to the OFF position once before restarting. In the interests of safety, however, this does not work if the counter displays 1.0m or less even if the lever is moved to the ON position.



Level Winder

* Be careful not to get your finger caught.

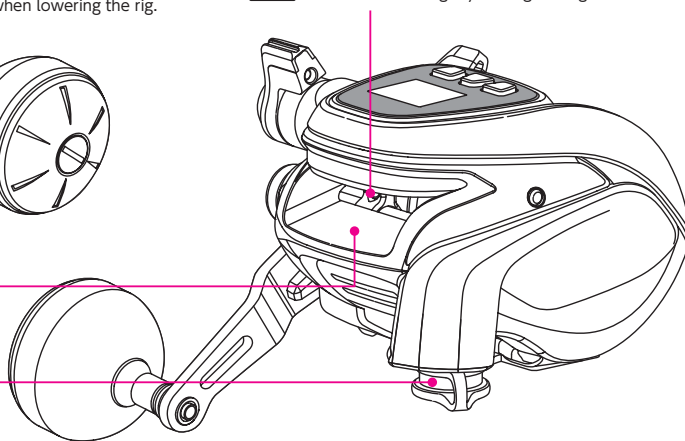

Power Supply : Cord

1 Handling Precautions

Power Supply

Use a power supply (such as a lithium battery) with a nominal voltage of 12 to 16.8V. When using a lithium battery, use a Shimano brand lithium battery. Use of batteries from other manufacturers may result in damage to the reel or battery. The reel cannot be used with non-specified power supplies (for example, residential 100V AC or high-voltage onboard boat power). Do not use battery chargers, etc.

- When using onboard power from a boat, make sure that it is direct current (DC) and between 12 and 16.8V. (When using a boat battery, only use a 12V battery or a battery with a DC-DC converter that converts 24V to 12V.) Note that the reel may not operate properly if the battery is rusty or the voltage unstable.
- Please use an adequately charged battery.
- When batteries are used for long periods of time, their charging capacity decreases. When this happens, exchange the battery for a new one.
- Do not connect to an AC power supply. This will damage the counter.

Power Cord

Always use a genuine Shimano power cord to connect your reel to the power supply. The power cord is a consumable. Depending on frequency of use, it may need to be changed every 2~3 years.

Caution : The reel may not operate properly if used with power cords other than a genuine Shimano power cord. Also be careful to handle the cord with care. Stepping on or bending the cord may cause it to fail.

The power cord alligator clips may draw a large current and become hot, when there is a large load on the motor. Please ensure that the alligator clips are firmly attached to the power supply (battery) terminals.

This product includes a special power cord designed to maximize motor power. Please be sure to use only the power cord that came with the reel.

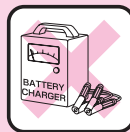
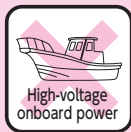
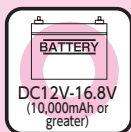

2 Connecting a Battery

- 1 Please use the supplied power cord to connect to the battery.

Firstly connect the red connector to the positive electrode and the black connector to the negative electrode.

* The reel may be damaged if the positive (+) and negative (-) leads are connected to the wrong terminals.

- 2 Next connect the power cord to the reel. Line up the connections and insert the power cord into the socket in the bottom of the reel, pushing it firmly in and then tightening the lock screw.

* Please do not push any buttons while connecting the power cord.

* A slight amount of play may occur in some products, but this will not cause problems during operation.

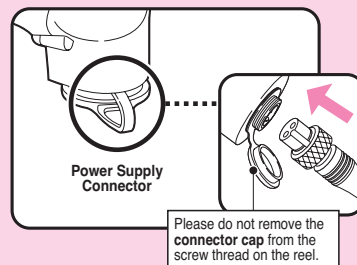

Learning Methods (Entering the actual line length into the reel.)

Spooling Up the Line

- 1** Feed the line through the level winder.
When threading the line, use the threading pin provided.

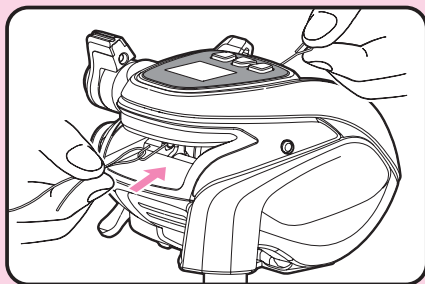

- 2** Tie the line to the spool pin.

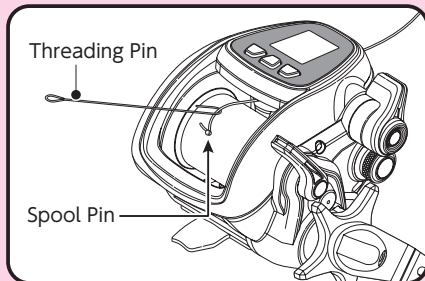

Selecting Learning Methods

Firstly, change from Water Depth Display to learning mode as shown below. Be sure to select the learning method that best matches the type of line you will be using. Please refer to the following page for details regarding each learning method.

- * This operation cannot be carried out unless a power supply is connected.
- * Carry out this operation when the display shows less than 6m. Please reset the counter if the value displayed is greater than 6.1m.

Caution

In some cases the display may go blank if learning is carried out at  insufficient voltage. If this happens, replace the battery and carry out learning again from the beginning.

Learning Mode

Water Depth Display

The reel is in this mode when the power is initially turned ON.
(* Initial screen)

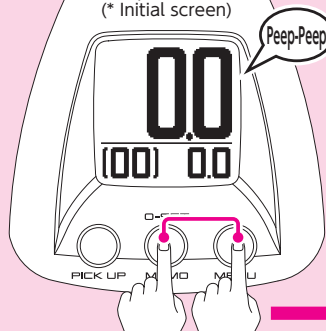

※Displays the function of the buttons in Line Learning Mode.

Press and hold both the O-SET and MENU buttons for 3 seconds to enter Line Learning Mode.
Note: This functions only when the Water Depth Display shows 6m or less.

Learning Method

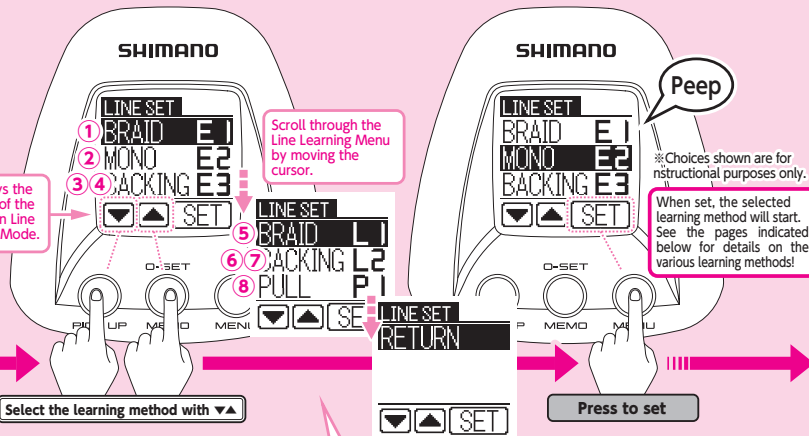

	Braided Line Learning (Not using backing line)	Braided Line Learning (Using backing line)	Finished using Backing Line Learning (Replacing the line)	Mono Line Learning (Not using backing line)	Pull-out Line Learning
If you know the actual length of line to be wound	① E1 P20	③ E3 P24	④ E3 P28	② E2 P22	
If you do not know the actual length of line to be wound	⑤ L1 P32	⑥ L2 P34	⑦ L2 P38		
If line has been completely wound in					⑧ P1 P42

Learning Methods (Inputting the actual value of the line use into the reel.)



1 If you are not using backing line and you know the actual length of line to be wound Braided Line Learning (E1)

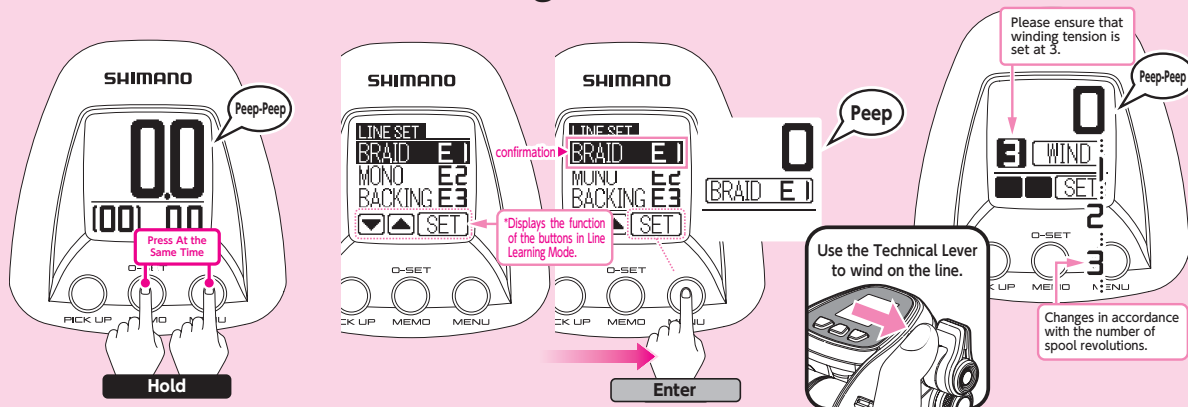

- 1 Carry out this operation with a counter value of 6m or less.
If the value displayed is 6.1m or more, reset the counter to 0 (see P38-39).
Set the clutch lever to ON.
Check that the power supply is connected.
The digital display will show the following. (When on the Water Depth Display.)
Press the O-SET button and the MENU button at the same time for more than 3 seconds to enter Learning Mode.

* Line Learning Mode cannot be accessed when in Demo Mode.

- 2 The Line Learning Menu will appear.
* The button functions change when in Line Learning Mode, so refer to their functions shown on the bottom row of the display.
Check that Braided Line Learning E1 is selected and press SET.
The display will change to the one shown above.
(See P18-19 for details on selecting learning methods.)

- 3 **Use the Technical Lever to wind on the line.**
The alarm will sound (peep-peep) and a number corresponding to the number of spool revolutions will be displayed.
Maintain a winding tension of 3 as shown on the display.
The winding tension value is an arbitrary numerical representation of the force (line tension) being experienced by the winding reel. The number does not equal kilograms.
When winding using the Technical Lever, the speed can be adjusted using the Technical Lever. To stop winding, move the Technical Lever to the OFF position.

Caution : The values and settings shown on the reel display in this manual are in some cases just examples. Actual values may differ.

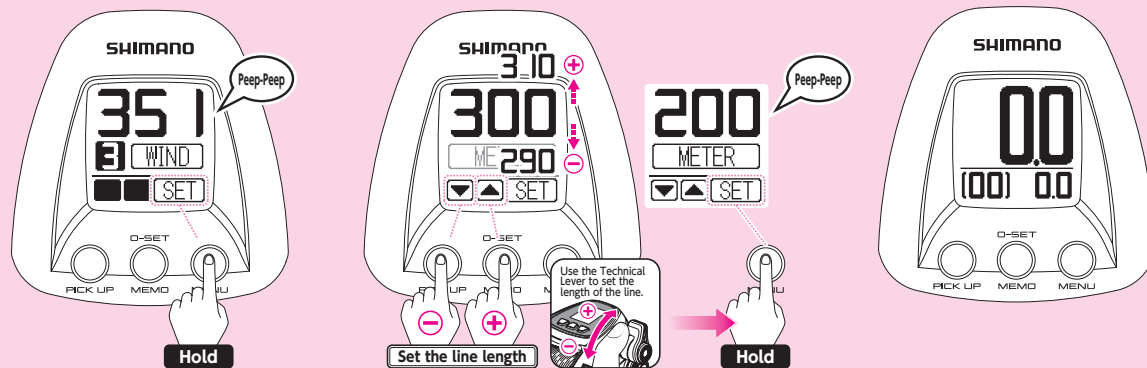

- 4** After completely finishing winding on the line, press the MENU button for more than 3 seconds.

The alarm will sound (peep-peep).

Note :

Do not wind on all of the line. Doing so will cause the counter value to be inaccurate.

- 5** Set the line length using the ▼▲ buttons or the Technical Lever and press and hold the MENU button for 3 seconds.

* The default setting is 300m.

(The diagram shows the setting changed from 300m to 200m.)

- 6** The display will return to the Water Depth Display; learning is now complete.

(Note that there may be as much as a $\pm 3\%$ difference between the counter value and the actual length of the line.)

* This difference is as of the first cast made after learning completion.

* If after actually fishing you feel that the difference is too great, carry out the Line Learning Adjustment operation as shown on P69-71. This will enable you to position your rig more accurately.

Learning Methods (Inputting the actual value of the line use into the reel.)

2 If you are not using backing line and you know the actual length of line to be wound Mono Line learning (E2)

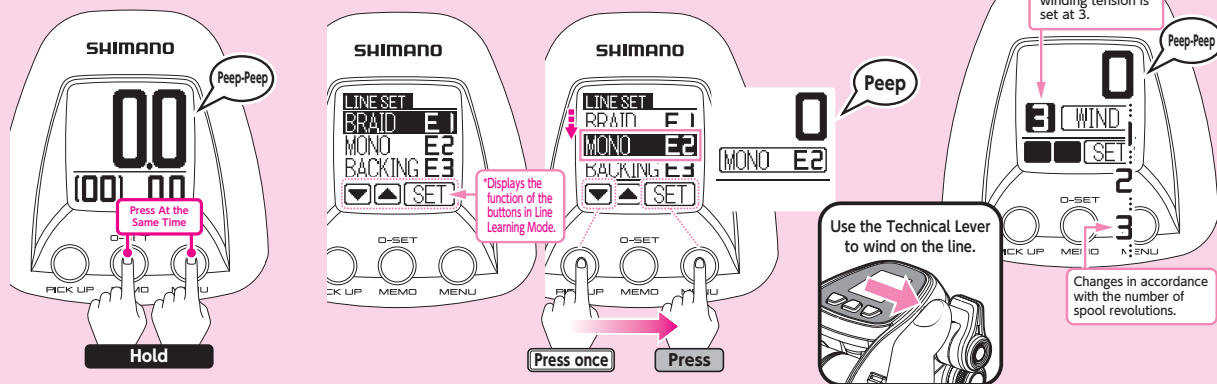

- 1 Carry out this operation with a counter value of 6m or less.
If the value displayed is 6.1m or more, reset the counter to 0 (see P38~39).
Set the clutch lever to ON. Check that the power supply is connected.
The digital display will show the following. (When on the Water Depth Display.)
Press the O-SET button and the MENU button at the same time for more than 3 seconds to enter Learning Mode.

* Line Learning Mode cannot be accessed when in Demo Mode.

- 2 The Line Learning Menu will appear.
* The button functions change when in Line Learning Mode, so refer to their functions shown on the bottom row of the display.
Use the ▼ button to select Mono Line Learning E2 and press SET. The display will change to the one shown above. (See P18~19 for details on selecting learning methods.)

- 3 **Use the Technical Lever to wind on the line.** The alarm will sound (peep-peep) and a number corresponding to the number of spool revolutions will be displayed.
Maintain a winding tension of 3 as shown on the display.
The winding tension value is an arbitrary numerical representation of the force (line tension) being experienced by the winding reel. The number does not equal kilograms.
When winding using the Technical Lever, the speed can be adjusted using the Technical Lever. To stop winding, move the Technical Lever to the OFF position.

Caution : The values and settings shown on the reel display in this manual are in some cases just examples. Actual values may differ.

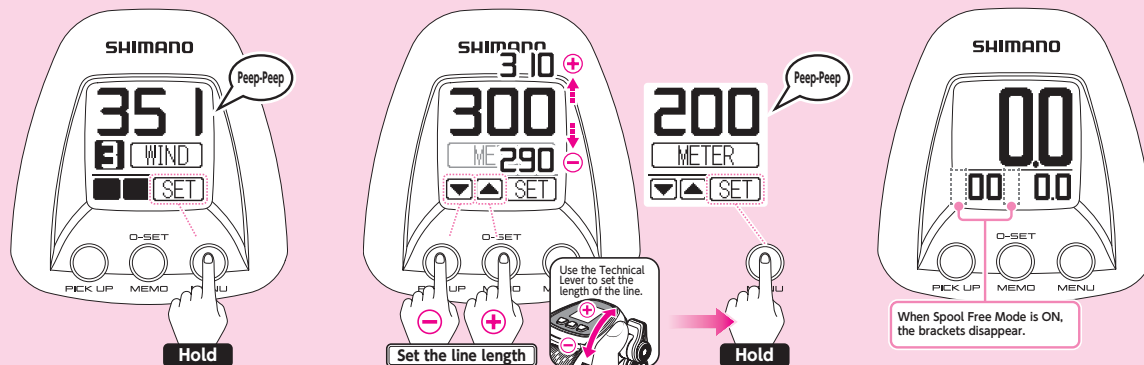

- 4** After completely finishing winding on the line, press the MENU button for more than 3 seconds.

The alarm will sound (peep-peep).

Note:

Do not wind on all of the line. Doing so will cause the counter value to be inaccurate.

- 5** Set the line length using the ▼ ▲ buttons or the Technical Lever and press and hold the MENU button for 3 seconds.

The alarm will sound (peep-peep).

* The default setting is 300m. (The diagram shows the setting changed from 300m to 200m.)

- 6** The display will return to the Water Depth Display; learning is now complete.

(Note that there may be as much as a $\pm 3\%$ difference between the counter value and the actual length of the line.)

* This difference is as of the first cast made after learning completion.

* If after actually fishing you feel that the difference is too great, carry out the Line Learning Adjustment operation as shown on P69-71. This will enable you to position your rig more accurately.

Once Mono Line Learning (E2) is set, () will disappear and Spool Free Mode will be turned on.

Learning Methods (Inputting the actual value of the line use into the reel.)

3 If you are using backing line and you know the actual length of line to be wound Backing Line Learning (E3)

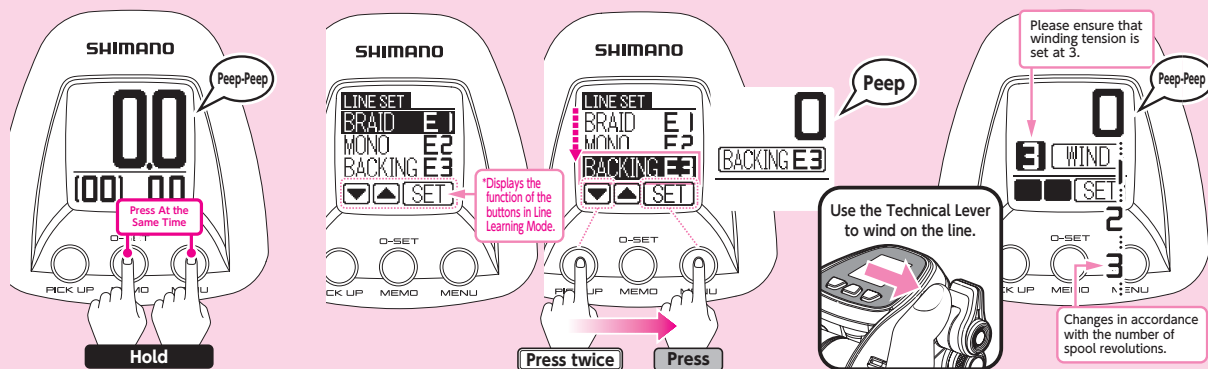

1 Carry out this operation with a counter value of 6m or less.

If the value displayed is 6.1m or more, reset the counter to 0 (see P38-39).

Set the clutch lever to ON.

Check that the power supply is connected.

The digital display will show the following. (When on the Water Depth Display.)

Press the O-SET button and the MENU button at the same time for more than 3 seconds to enter Learning Mode.

* Line Learning Mode cannot be accessed when in Demo Mode.

2 The Line Learning Menu will appear.

* The button functions change when in Line Learning Mode, so refer to their functions shown on the bottom row of the display.

Use the ▼ button to select Backing Line Learning E3 and press SET.

The display will change to the one shown above.

(See P18-19 for details on selecting learning methods.)

3 **Use the Technical Lever to wind on the line.**

The alarm will sound (peep-peep) and a number corresponding to the number of spool revolutions will be displayed.

Maintain a winding tension of 3 as shown on the display.

The winding tension value is an arbitrary numerical representation of the force (line tension) being experienced by the winding reel. The number does not equal kilograms.

When winding using the Technical Lever, the speed can be adjusted using the Technical Lever. To stop winding, move the Technical Lever to the OFF position.

Caution : The values and settings shown on the reel display in this manual are in some cases just examples. Actual values may differ.

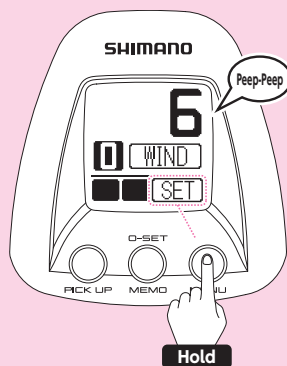

- 4** After finishing winding on the backing line, press the MENU button for more than 3 seconds.

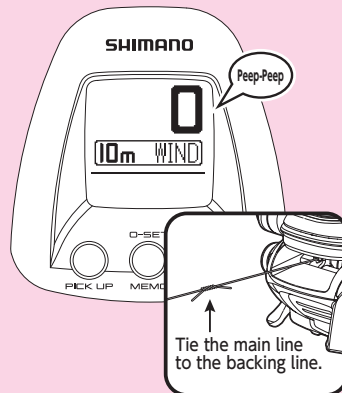

- 5** The alarm will sound (peep-peep) and the display will appear as shown in the diagram.
Once winding-on is finished, tie the main line to the backing line.

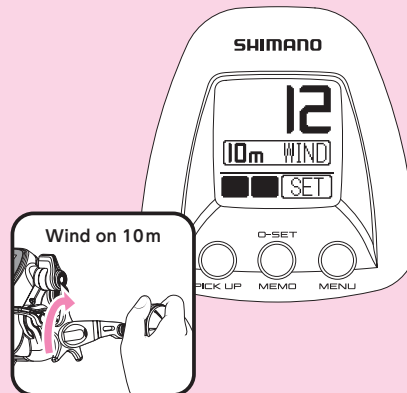

- 6** Wind on precisely 10m of main line.
The display will change in accordance with the number of spool revolutions.

Caution: When winding on 10m of line

The "10" shown on the display does not indicate 10m of line.

- If there is a marker on the line, you must gauge 10m yourself using the marker.
- If there is no marker on the line, you must use a tape measure or similar to measure 10m.

Continued on the next page. ➔

Caution : The values and settings shown on the reel display in this manual are in some cases just examples. Actual values may differ.

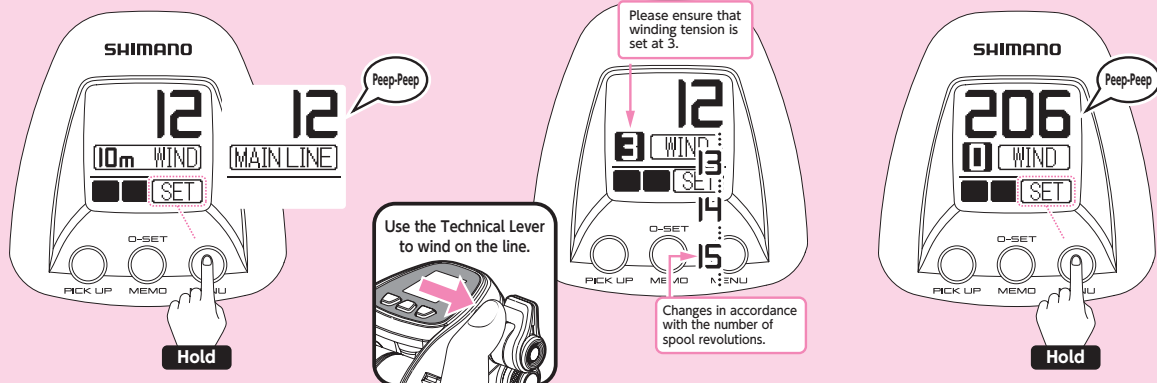

- 7** Press the MENU button for more than 3 seconds. The alarm will sound (peep-peep) and the display will appear as shown in the diagram.

- 8** Use the Technical Lever to wind on the line. A number corresponding to the number of spool revolutions will be displayed. **Maintain a winding tension of 3 as shown on the display.** The winding tension value is an arbitrary numerical representation of the force (line tension) being experienced by the winding reel. The number does not equal kilograms. **When winding using the Technical Lever, the speed can be adjusted using the Technical Lever. To stop winding, move the Technical Lever to the OFF position.**

- 9** After completely finishing winding on the line, press the MENU button for more than 3 seconds. The alarm will sound (peep-peep).

Note:

Do not wind on all of the line. If all of the line is wound on, it will cause an error in the counter value.

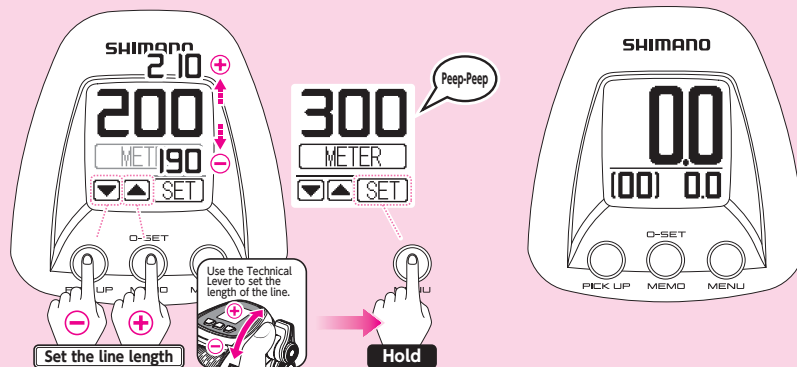

- 10** Set the line length using the ▼ ▲ buttons or the Technical Lever and press and hold the MENU button for 3 seconds.

The alarm will sound (peep-peep).

* The default setting is 200m. (The diagram shows the setting changed from 200m to 300m.)

- 11** The display will return to the Water Depth Display; learning is now complete.

(Note that there may be as much as a $\pm 3\%$ difference between the counter value and the actual length of the line.)

* This difference is as of the first cast made after learning completion.

* If after actually fishing you feel that the difference is too great, carry out the Line Learning Adjustment operation as shown on P69-71. This will enable you to position your rig more accurately.

Learning Methods (Inputting the actual value of the line use into the reel.)

4 If you have finished using backing line (when replacing the line) and you know the actual length of the line to be wound

Backing Line Learning (E3)

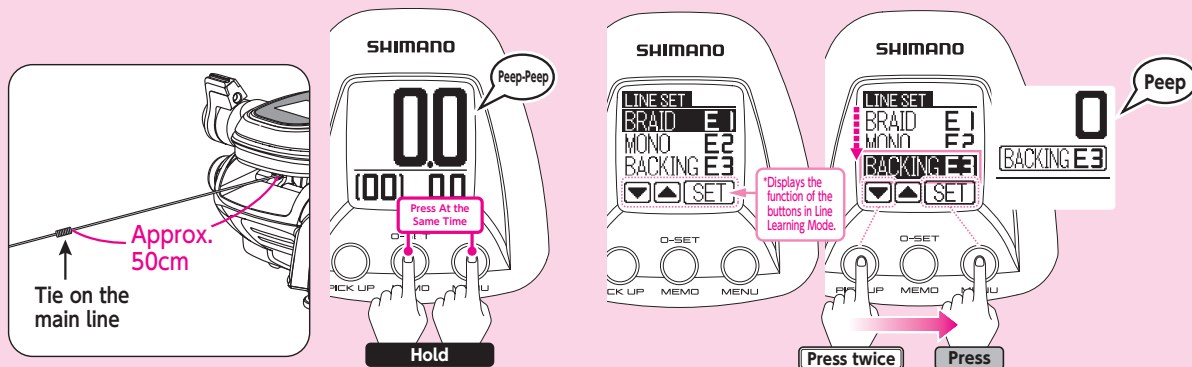

1 Tie the main line on to the backing line that has been wound on.

* When tying the main line on to the backing line, thread the backing line through the eye of the Level Winder, pulling out approximately 50cm of backing line before tying on the main line.

* Line Learning Mode cannot be accessed when in Demo Mode.

Initiate line learning with approximately 50cm of backing line pulled out.

2 Carry out this operation with a counter value of 6m or less.

If the value displayed is 6.1m or more, reset the counter to 0 (see P57-59).

Set the clutch lever to ON.

Check that the power supply is connected.

The digital display will show the following. (When on the Water Depth Display.)

Press the O-SET button and the MENU button at the same time for more than 3 seconds to enter Learning Mode.

3 The Line Learning Menu will appear.

* The button functions change when in Line Learning Mode, so refer to their functions shown on the bottom row of the display.

Use the ▼ button to select Backing Line Learning E3 and press SET.

The display will change to the one shown above.

(See P18-19 for details on selecting learning methods.)

Caution : The values and settings shown on the reel display in this manual are in some cases just examples. Actual values may differ.

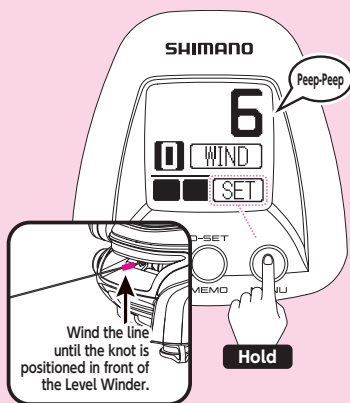

- 4** Once you have wound on the line with the knot up to the handle like in the diagram above, the above screen will be displayed. Press and hold the MENU button for more than 3 seconds.

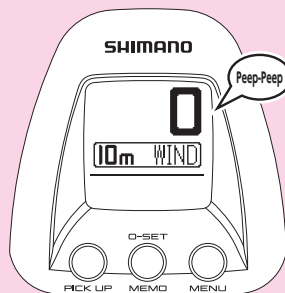

- 5** The alarm will sound (peep-peep) and the display will appear as shown in the diagram.

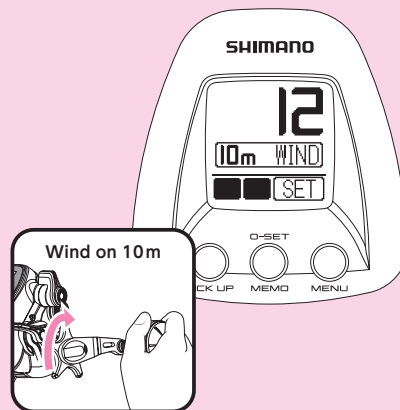

- 6** Wind on precisely 10m of main line. The display will change in accordance with the number of spool revolutions.

Caution: When winding on 10m of line

The "10" shown on the display does not indicate 10m of line.

- If there is a marker on the line, you must gauge 10m yourself using the marker.
- If there is no marker on the line, you must use a tape measure or similar to measure 10m.

Continued on the next page. ➔

Caution : The values and settings shown on the reel display in this manual are in some cases just examples. Actual values may differ.

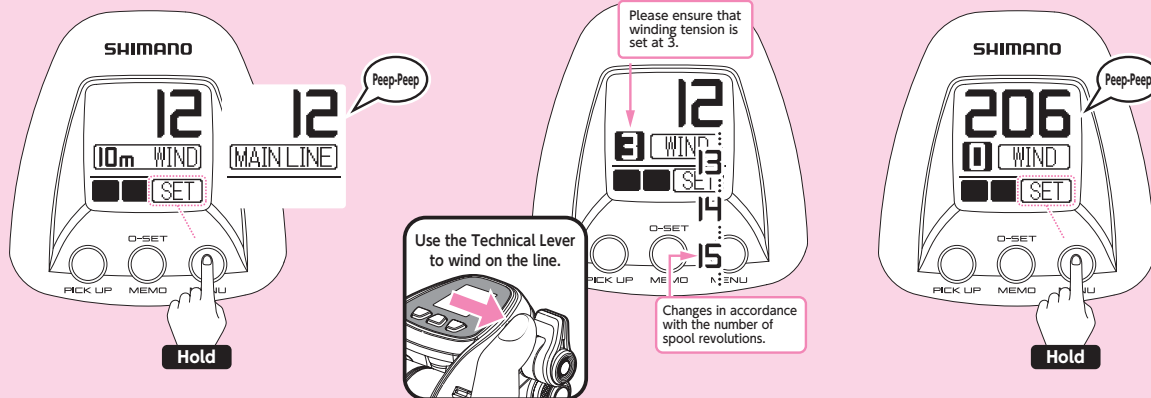

- 7** Press the MENU button for more than 3 seconds.
The alarm will sound (peep-peep) and the display will appear as shown in the diagram.

- 8** Use the Technical Lever to wind on the line.
A number corresponding to the number of spool revolutions will be displayed.
Maintain a winding tension of 3 as shown on the display.
The winding tension value is an arbitrary numerical representation of the force (line tension) being experienced by the winding reel. The number does not equal kilograms.
When winding using the Technical Lever, the speed can be adjusted using the Technical Lever. To stop winding, move the Technical Lever to the OFF position.

- 9** After completely finishing winding on the line, press the MENU button for more than 3 seconds.
The alarm will sound (peep-peep).

Note :

Do not wind on all of the line. Doing so will cause the counter value to be inaccurate.

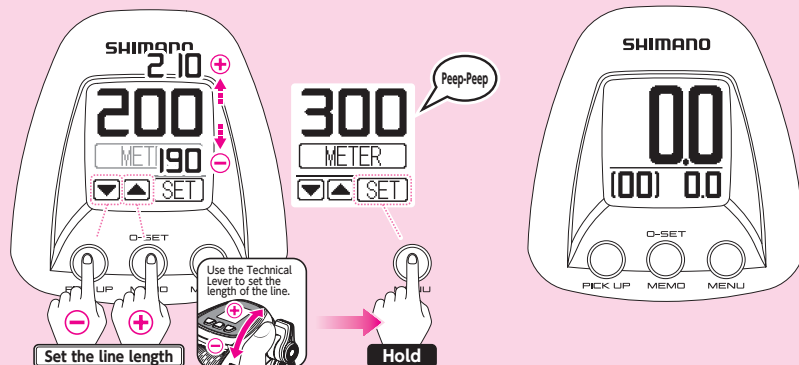

- 10** Set the line length using the ▼ ▲ buttons or the Technical Lever and press and hold the **MENU** button for 3 seconds.

The alarm will sound (peep-peep).

* The default setting is 200m. (The diagram shows the setting changed from 200m to 300m.)

- 11** The display will return to the **Water Depth Display**; learning is now complete.

(Note that there may be as much as a $\pm 3\%$ difference between the counter value and the actual length of the line.)

- * This difference is as of the first cast made after learning completion.
- * If after actually fishing you feel that the difference is too great, carry out the Line Learning Adjustment operation as shown on P69-71. This will enable you to position your rig more accurately.

Learning Methods (Inputting the actual value of the line use into the reel.)

5 If you are not using backing line and you do not know the actual length of line to be wound Backing Line Learning (L1)

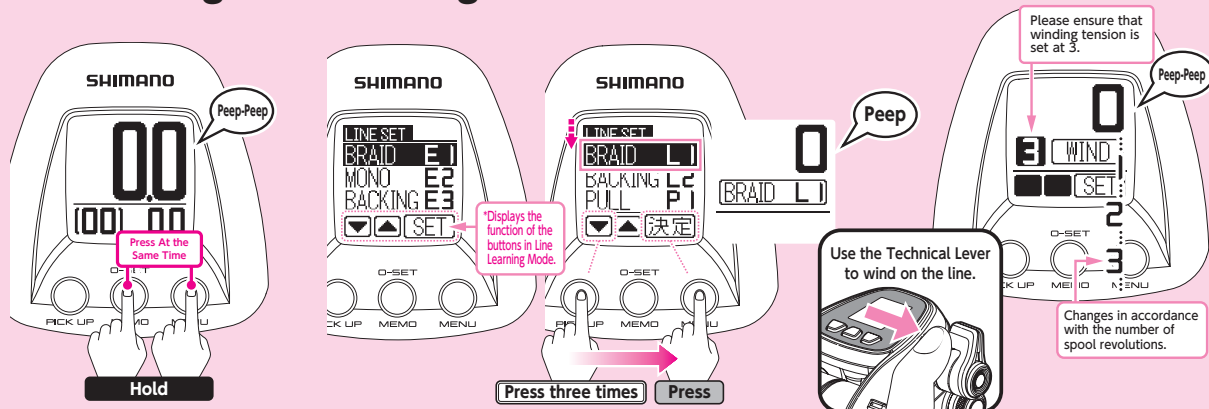

- 1 Carry out this operation with a counter value of 6m or less.

If the value displayed is 6.1m or more, reset the counter to 0 (see P38-39).

Set the clutch lever to ON. Check that the power supply is connected.

The digital display will show the following.

(When on the Water Depth Display.)

Press the O-SET button and the MENU button at the same time for more than 3 seconds to enter Learning Mode.

* Line Learning Mode cannot be accessed when in Demo Mode.

- 2 The Line Learning Menu will appear.

* The button functions change when in Line Learning Mode, so refer to their functions shown on the bottom row of the display.

Use the ▼ button to select Braided Line Learning L1 and press SET.

The display will change to the one shown above.

(See P18-19 for details on selecting learning methods.)

- 3 Use the Technical Lever to wind on the line.

The alarm will sound (peep-peep) and a number corresponding to the number of spool revolutions will be displayed.

Maintain a winding tension of 3 as shown on the display.

The winding tension value is an arbitrary numerical representation of the force (line tension) being experienced by the winding reel. The number does not equal kilograms.

When winding using the Technical Lever, the speed can be adjusted using the Technical Lever. To stop winding, move the Technical Lever to the OFF position.

Caution : The values and settings shown on the reel display in this manual are in some cases just examples. Actual values may differ.

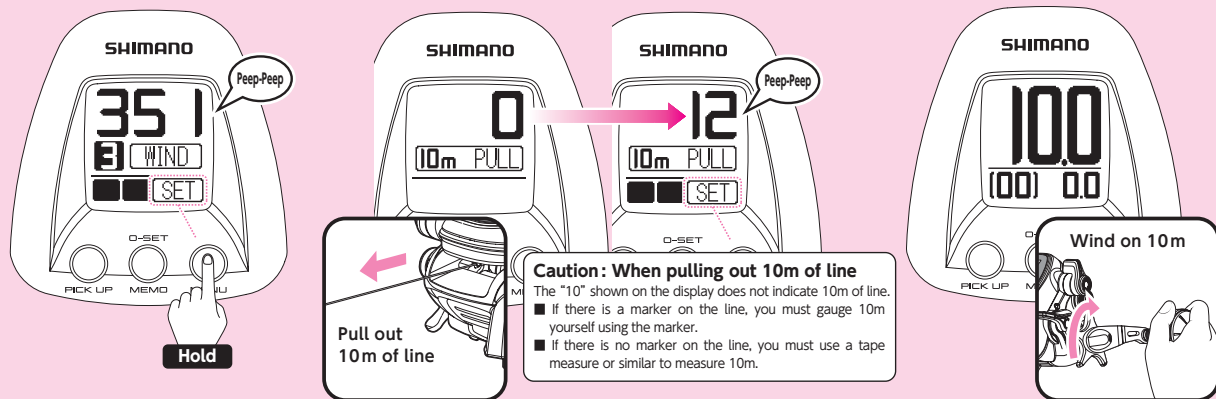

- 4** After completely finishing winding on the line, press the MENU button for more than 3 seconds.

The alarm will sound (peep-peep).

Note:

Do not wind on all of the line. Doing so will cause the counter value to be inaccurate.

- 5** Pull out precisely 10m of main line. (If available, use the line's 10m length color changes or 1m length indicators.) To finish learning, press the MENU button for more than 3 seconds.

The alarm will sound (peep-peep).

- 6** The display will return to the Water Depth Display; learning is now complete.

(Note that there may be as much as a $\pm 3\%$ difference between the counter value and the actual length of the line.)

* This difference is as of the first cast made after learning completion.

* If after actually fishing you feel that the difference is too great, carry out the Line Learning Adjustment operation as shown on P69-71. This will enable you to position your rig more accurately.

- 7** Wind on the 10m of line that was pulled out.

Learning Methods (Inputting the actual value of the line use into the reel.)

6 If you are using backing line and you do not know the actual length of line to be wound Backing Line Learning (L2)

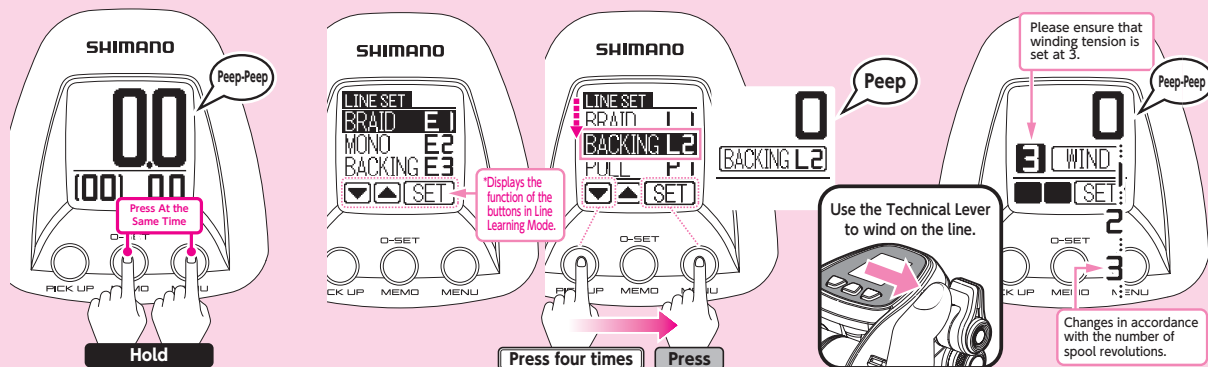

- 1 Carry out this operation with a counter value of 6m or less.

If the value displayed is 6.1m or more, reset the counter to 0 (see P38~39).

Set the clutch lever to ON.

Check that the power supply is connected.

The digital display will show the following. (When on the Water Depth Display.)

Press the D-SET button and the MENU button at the same time for more than 3 seconds to enter Learning Mode.

* Line Learning Mode cannot be accessed when in Demo Mode.

- 2 The Line Learning Menu will appear.

* The button functions change when in Line Learning Mode, so refer to their functions shown on the bottom row of the display.

Use the ∇ button to select Backing Line Learning L2 and press SET.

The display will change to the one shown above.

(See P18~19 for details on selecting learning methods.)

- 3 Use the Technical Lever to wind on the line.

The alarm will sound (peep-peep) and a number corresponding to the number of spool revolutions will be displayed.

Maintain a winding tension of 3 as shown on the display.

The winding tension value is an arbitrary numerical representation of the force (line tension) being experienced by the winding reel. The number does not equal kilograms.

When winding using the Technical Lever, the speed can be adjusted using the Technical Lever. To stop winding, move the Technical Lever to the OFF position.

Caution : The values and settings shown on the reel display in this manual are in some cases just examples. Actual values may differ.

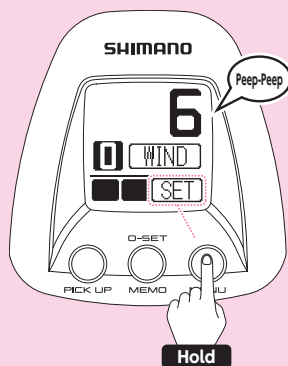

- 4** After finishing winding on the backing line, press the MENU button for more than 3 seconds.

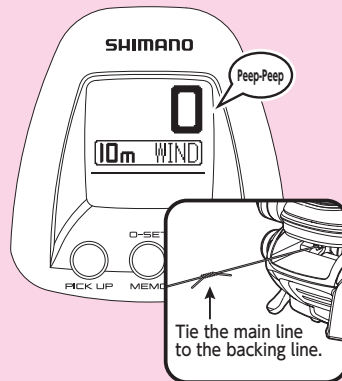

- 5** The alarm will sound (peep-peep) and the display will appear as shown in the diagram.

The alarm will sound (peep-peep) and the display will appear as shown in the diagram.

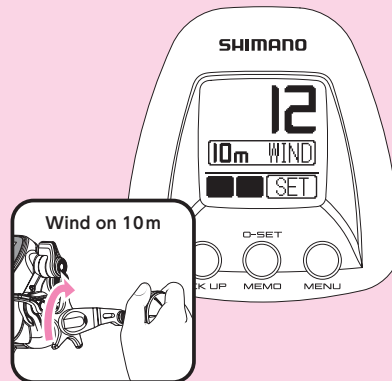

- 6** Wind on precisely 10m of main line. The display will change in accordance with the number of spool revolutions.

Caution: When winding on 10m of line

The "10" shown on the display does not indicate 10m of line.

- If there is a marker on the line, you must gauge 10m yourself using the marker.
- If there is no marker on the line, you must use a tape measure or similar to measure 10m.

Continued on the next page. ➔

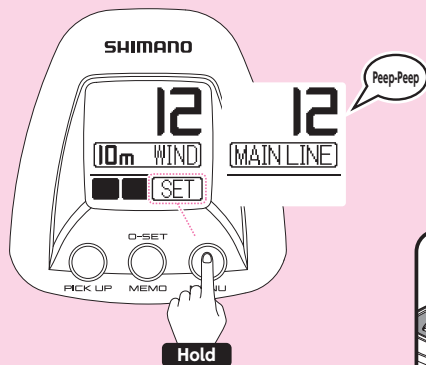

- 7** Press the MENU button for more than 3 seconds.

The alarm will sound (peep-peep) and the display will appear as shown in the diagram.

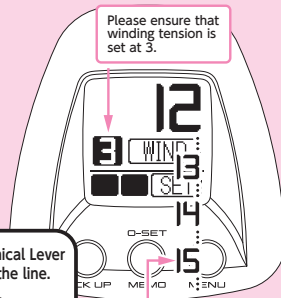

- 8** Use the Technical Lever to wind on the line.

A number corresponding to the number of spool revolutions will be displayed. Maintain a winding tension of 3 as shown on the display.

The winding tension value is an arbitrary numerical representation of the force (line tension) being experienced by the winding reel. The number does not equal kilograms.

When winding using the Technical Lever, the speed can be adjusted using the Technical Lever. To stop winding, move the Technical Lever to the OFF position.

Changes in accordance with the number of spool revolutions.

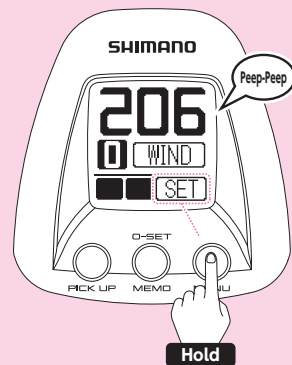

- 9** After completely finishing winding on the line, press the MENU button for more than 3 seconds.

The alarm will sound (peep-peep).

Note:

Do not wind on all of the line. Doing so will cause the counter value to be inaccurate.

Caution : The values and settings shown on the reel display in this manual are in some cases just examples. Actual values may differ.

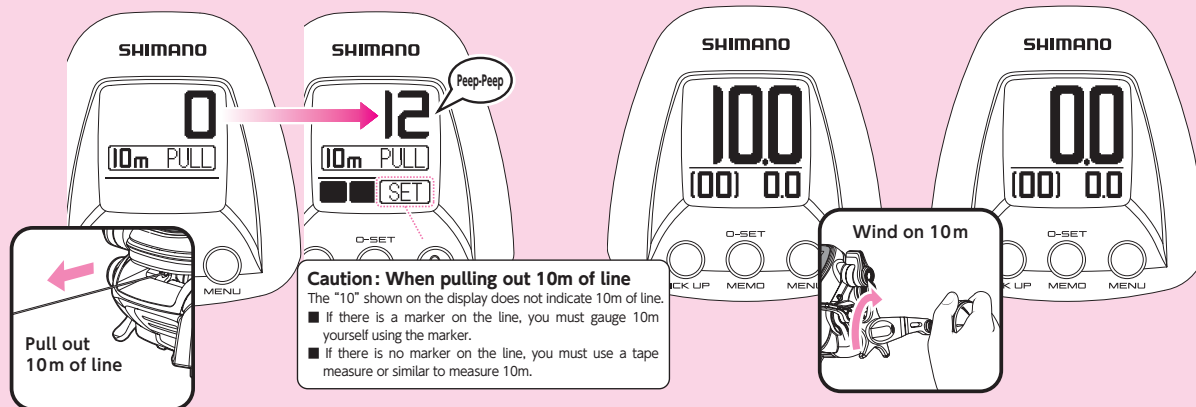

- 10** Pull out precisely 10m of main line. (If available, use the line's 10m length color changes or 1m length indicators.)
 To finish learning, press the **MENU** button for more than 3 seconds.
 The alarm will sound (peep-peep).

- 11** The display will return to the **Water Depth Display**; learning is now complete.
 (Note that there may be as much as a $\pm 3\%$ difference between the counter value and the actual length of the line.)
 * This difference is as of the first cast made after learning completion.
 * If after actually fishing you feel that the difference is too great, carry out the Line Learning Adjustment operation as shown on P69~71. This will enable you to position your rig more accurately.

- 12** Wind on the 10m of line that was pulled out.

Learning Methods (Inputting the actual value of the line use into the reel.)

7 If you have finished using backing line (when replacing the line) and you do not know the actual length of the line to be wound

Backing Line Learning (L2)

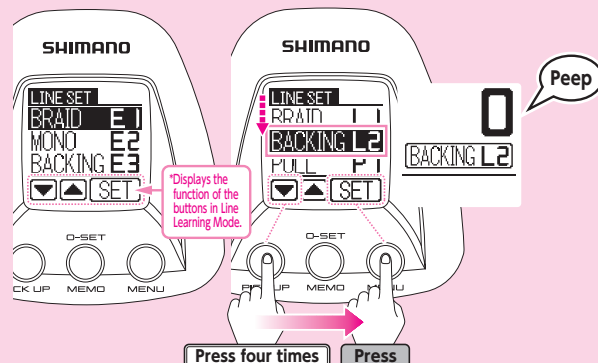
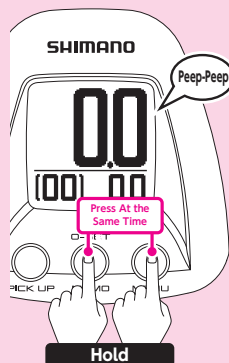
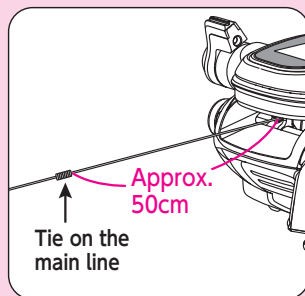

1 Tie the main line on to the backing line that has been wound on.

* When tying the main line on to the backing line, thread the backing line through the eye of the Level Winder, pulling out approximately 50cm of backing line before tying on the main line.

* Line Learning Mode cannot be accessed when in Demo Mode.

Initiate line learning with approximately 50cm of backing line pulled out.

2 Carry out this operation with a counter value of 6m or less.

If the value displayed is 6.1m or more, reset the counter to 0 (see P51~52).

Set the clutch lever to ON.

Check that the power supply is connected.

The digital display will show the following. (When on the Water Depth Display.)

Press the O-SET button and the MENU button at the same time for more than 3 seconds to enter Learning Mode.

3 The Line Learning Menu will appear.

* The button functions change when in Line Learning Mode, so refer to their functions shown on the bottom row of the display.

Use the ▼ button to select Backing Line Learning L2 and press SET.

The display will change to the one shown above.

(See P18~19 for details on selecting learning methods.)

Caution : The values and settings shown on the reel display in this manual are in some cases just examples. Actual values may differ.

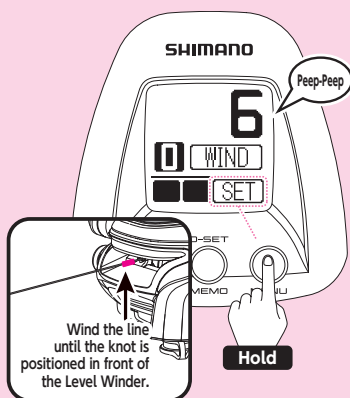

- 4** Once you have wound on the line with the knot up to the handle like in the diagram above, the above screen will be displayed. Press and hold the MENU button for more than 3 seconds.

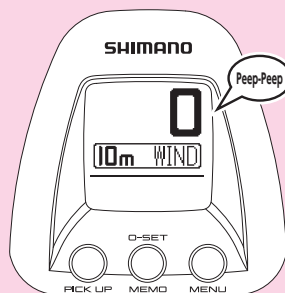

- 5** The alarm will sound (peep-peep) and the display will appear as shown in the diagram.

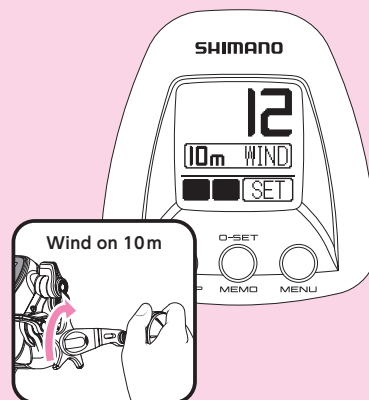

- 6** Wind on precisely 10m of main line. The display will change in accordance with the number of spool revolutions.

Caution: When winding on 10m of line

The "10" shown on the display does not indicate 10m of line.

- If there is a marker on the line, you must gauge 10m yourself using the marker.
- If there is no marker on the line, you must use a tape measure or similar to measure 10m.

Continued on the next page. ➔

Caution : The values and settings shown on the reel display in this manual are in some cases just examples. Actual values may differ.

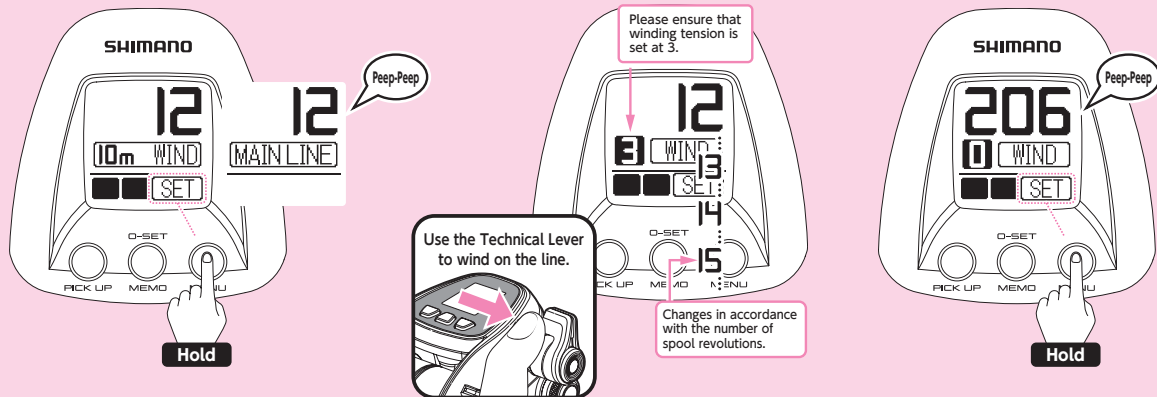

- 7** Press the MENU button for more than 3 seconds.
The alarm will sound (peep-peep) and the display will appear as shown in the diagram.

- 8** Use the Technical Lever to wind on the line.
A number corresponding to the number of spool revolutions will be displayed.
Maintain a winding tension of 3 as shown on the display.
The winding tension value is an arbitrary numerical representation of the force (line tension) being experienced by the winding reel. The number does not equal kilograms.
When winding using the Technical Lever, the speed can be adjusted using the Technical Lever. To stop winding, move the Technical Lever to the OFF position.

- 9** After completely finishing winding on the line, press the MENU button for more than 3 seconds.
The alarm will sound (peep-peep).

Note:

Do not wind on all of the line. Doing so will cause the counter value to be inaccurate.

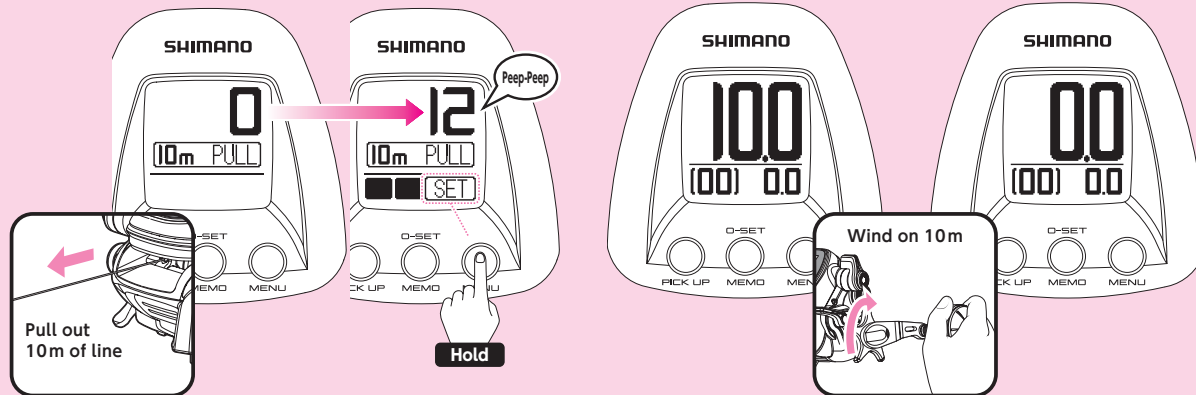

- 10** Pull out precisely 10m of main line. (If available, use the line's 10m length color changes or 1m length indicators.)
To finish learning, press the **MENU** button for more than 3 seconds.
The alarm will sound (peep-peep).

Caution: When pulling out 10m of line

- The "10" shown on the display does not indicate 10m of line.
- If there is a marker on the line, you must gauge 10m yourself using the marker.
 - If there is no marker on the line, you must use a tape measure or similar to measure 10m.

- 11** The display will return to the **Water Depth Display**; learning is now complete. (Note that there may be as much as a $\pm 3\%$ difference between the counter value and the actual length of the line.)

* This difference is as of the first cast made after learning completion.

* If after actually fishing you feel that the difference is too great, carry out the Line Learning Adjustment operation as shown on P69-71. This will enable you to position your rig more accurately.

- 12** Wind on the 10m of line that was pulled out.

8 If you are pulling out line for Line Learning when the line has been completely wound in Pull-out Line Learning (P1)

A convenient way to pull out line and re-enter Line Learning after the line has been completely wound in.
Note: Pull-out Line Learning requires that the line wound on your reel to be 100m or greater.

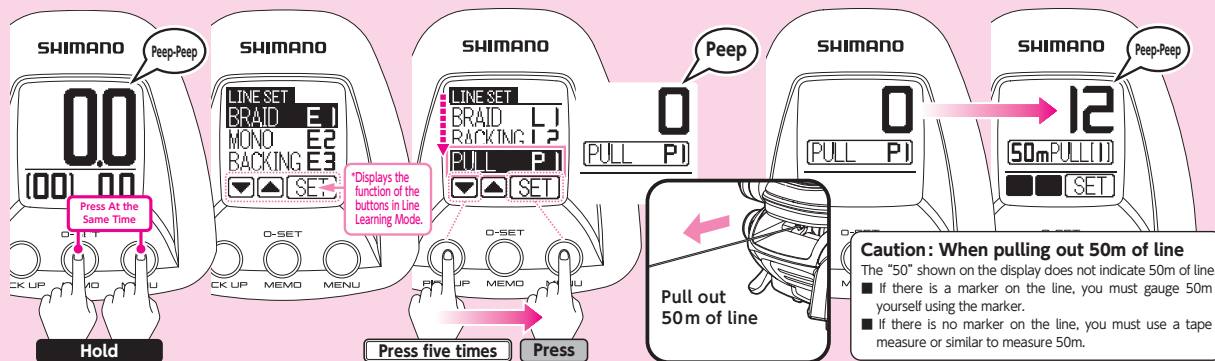

- 1 Carry out this operation with a counter value of 6m or less.
If the value displayed is 6.1m or more, reset the counter to 0 (see P57-59).
Check that the power supply is connected.
The digital display will show the following. (When on the Water Depth Display.)
Press the O-SET button and the MENU button at the same time for more than 3 seconds to enter Learning Mode.

* Line Learning Mode cannot be accessed when in Demo Mode.

- 2 The Line Learning Menu will appear.
* The button functions change when in Line Learning Mode, so refer to their functions shown on the bottom row of the display.
Use the ▼ button to select Pull-out Line Learning P1 and press SET.

The display will change to the one shown above.
(See P18~19 for details on selecting learning methods.)

- 3 Set the clutch lever to OFF and pull out precisely 50m of line.
(If available, use the line's 10m length color changes or 1m length indicators.)

Caution : The values and settings shown on the reel display in this manual are in some cases just examples. Actual values may differ.

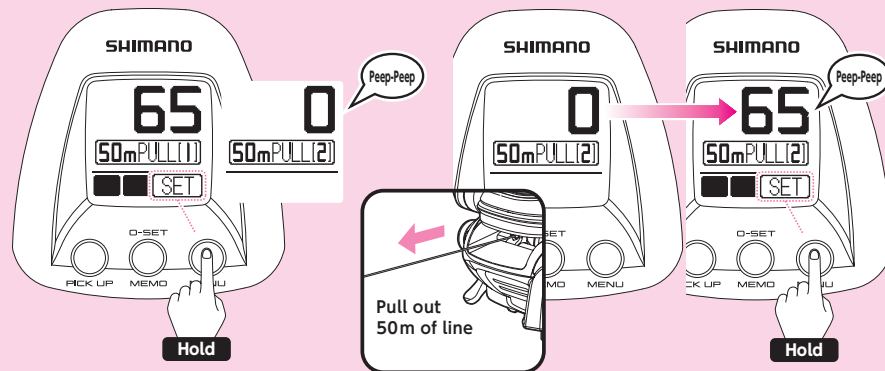

4 After pulling out 50m of line, press the MENU button for more than 3 seconds. The alarm will sound (peep-peep) and the display will appear as shown in the diagram.

5 Pull out precisely 50m of additional line. (If available, use the line's 10m length color changes or 1m length indicators.) After pulling out 50m of line, press the MENU button for more than 3 seconds. The alarm will sound (peep-peep).

Continued on the next page. ➔

Caution : The values and settings shown on the reel display in this manual are in some cases just examples. Actual values may differ.

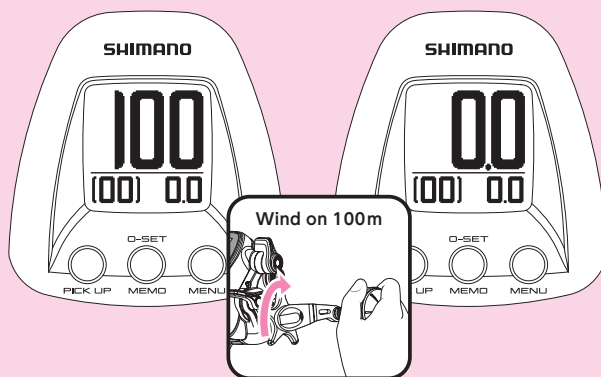

6 The display will return to the Water Depth Display; learning is now complete.

(Note that there may be as much as a $\pm 3\%$ difference between the counter value and the actual length of the line.)

* This difference is as of the first cast made after learning completion.

* If after actually fishing you feel that the difference is too great, carry out the Line Learning Adjustment operation as shown on P69-71. This will enable you to position your rig more accurately.

7 Wind on the 100m of line that was pulled out.

Various Techniques (You will want to learn these techniques to improve your catch.)



Technique

Drop Your Rig Quickly

- Normally, the mechanical brake knob is tightened to slightly brake the free rotation of the spool to prevent backlash due to the up/down movement of the vessel.
- However, a faster way to drop your rig is to not tighten the mechanical brake knob and to control the speed of the spool with pressure from your thumb or fingers.

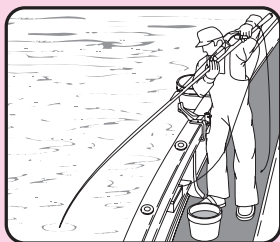

- Aim the tip of the rod down and stand the rod up to reduce guide resistance as shown above.

You can also use the techniques shown below.



- This reel has an Auto Dropping Function. The motor automatically starts when the rig is 5m or more past the gunwale stop position and spool resistance is minimized. The motor automatically stops when the clutch is returned.

* As the motor is in operation during Auto Dropping, engaging the clutch will cause the line to be slightly wound in but this is not abnormal.

- Point the tip of the rod downward to reduce guide resistance as shown in the picture on the right.

Note :

When using the Auto Dropping Function, the line will automatically be wound on if the clutch is engaged while the motor is on. Ensure the motor is not in operation (Technical Lever is set to OFF) before engaging the clutch.

Turning ON the Auto Dropping Function

The Auto Dropping Function is initially set to ON. Follow the instructions below to turn this function OFF.

1. Press and hold down the **MENU** button in the Water Depth Display for more than 3 seconds for the Menu Screen to appear.
2. Use **▼▲** and select **FREE**.
3. Use **▼▲** and select **ON** or **OFF** and press **SET**.

Please see Pages 11 ~ 14 for details regarding menu button operation.

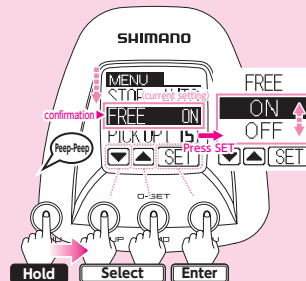

Zero Setting (Always do this before you start fishing.)



Accurately reach your target fishing depth.

If you want to improve your catch you must be able to position your rig accurately at the target depth. Zero setting resets the counter to zero when the rig is on the surface. Zero setting enables you to know the depth of the rig and to accurately position it at the target depth.

* Do not wind too much line onto the spool as this can cause inaccurate readings when setting zero in one of the Learning Modes.

* If you carry out zero setting when the depth display shows 10.1m or more, line breakage compensation will be carried out.

Caution! — In order to prevent the rig from twisting around the tip of your rod —

Do zero the counter immediately after you have reeled in a large catch that created strong tension.

When you have caught on to something large, your line may stretch or break causing variation to the diameter of the wound spool, making the Gunwale Stop Position inaccurate.

By zeroing the counter in this situation, the difference in tension on your next cast compared to the tension of your previous wind on will be greater and the counter display will not be accurate. This may cause the rig to twist around the tip of the rod and damage the tip of the rod.

This is one of the characteristics of the electric reel and this phenomenon cannot be completely avoided, so please pay careful attention when zeroing the counter.

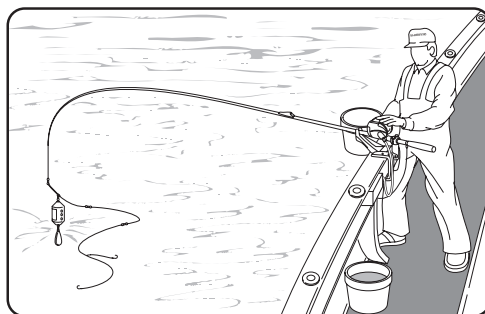

The counter can be reset to 0m when the rig is on the surface.

Let's Try Zero Setting



Caution

Do not wind too much line onto the spool as this can cause inaccurate readings when setting zero in one of the Learning Modes.

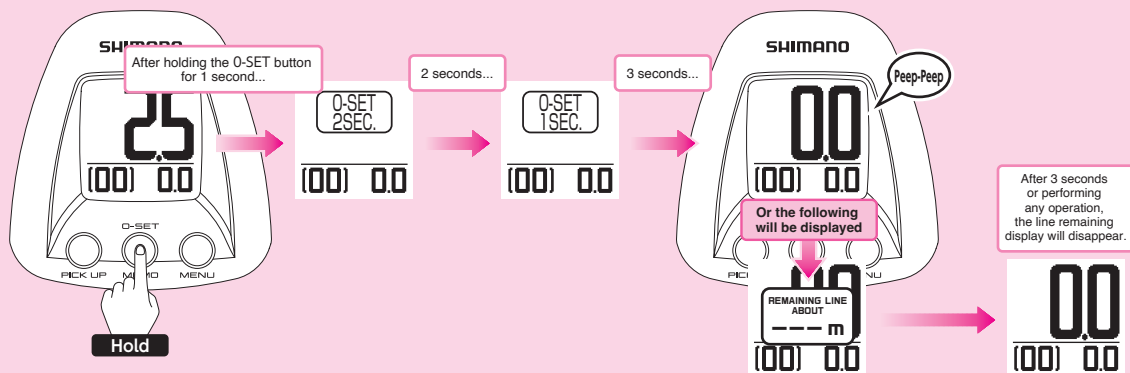

- 1 Lower the rig to the surface of the water, then press the O-SET button for more than 3 seconds.

- 2 The alarm will sound (peep-peep) and the display will change as shown in the diagram.

The counter has now been reset to 0.

Condition resulting in the line remaining display being shown

The line remaining display will be shown when the counter has been adjusted after using the Line Learning function.

* "----" may be shown before using the Line Learning function.

* The amount of line remaining can also be checked from REEL DATA in the menu (see P28).

Note regarding line remaining display

When the counter has been reset to 0 while the Water Depth Display shows under ± 10 , the Line Learning function will not make any adjustments and the remaining line length will not be updated.

Adjusting Smart Line Depth



This function allows you to easily return your rig to the same depth after repairing your line if it breaks.

* If you carry out zero setting when the depth display shows 10.1m or more, line breakage compensation will be carried out.

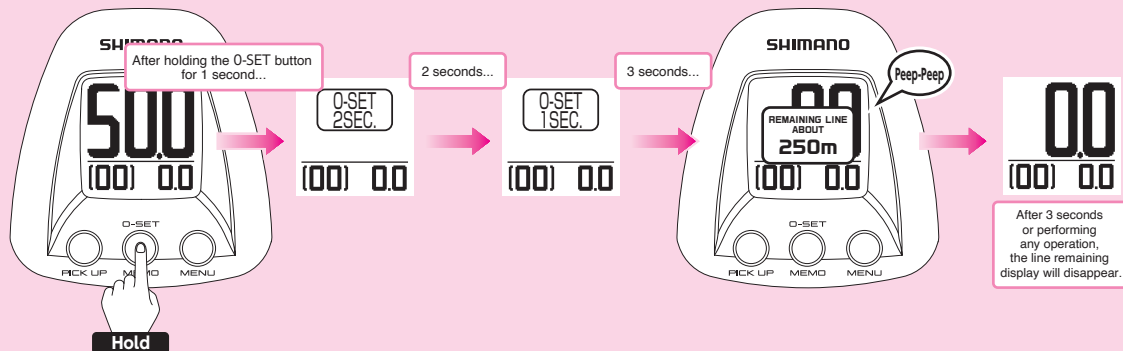

- 1** Lower the rig to the surface of the water, then press the **▲** button for more than 3 seconds.

* The example screens shown are those displayed when EJ Mode is OFF.

- 2** The display will change to one like that shown above. The computer will automatically update the program to display the actual value measured from the location of the break.
Condition resulting in the line remaining display being shown
The line remaining display will be shown when the counter has been adjusted after using the Line Learning function.

* The amount of line remaining can also be checked from REEL DATA in the menu (see P28).

Note regarding line remaining display

When the counter has been reset to 0 while the Water Depth Display shows under ± 10 , the Line Learning function will not make any adjustments and the remaining line length will not be updated.

S A-RB



Shielded Anti-Rust Bearings provide even smoother operation.

A special corrosion-resistant material is applied to the surface of conventional antirust bearings to minimize saltwater penetration and these bearings are located at strategic locations to achieve even smoother performance.

These enable dramatically improved casting performance when fishing for spear squid, as well as improved float fishing performance — something that was said to be difficult to achieve with a powered reel.

This has been made possible by the optimum balance that has been achieved between the safety bar and the level winder, which is the part that is said to cause line tangles when float fishing.

Not only are these bearings resistant to rust, but they also minimize the formation of salt crystals inside the bearings, which can lead to corrosion.

S A-RB

Automatic Gunwale Stop



Automatic Gunwale Stop Position can be set to automatic or manual.

■ When set to automatic

**When the motor stops,
just raise your rod vertical and the rig will come straight to your hand.**

You can set the reel so that when the motor stops retrieving the line you just need to raise your rod vertical to have the rig come straight to your hand.

* When connecting to a power source for the first time the Gunwale Stop is set at 6m.

From the second time onwards, the position at which the reel is stopped for more than 5 seconds will automatically be remembered by the computer as the Gunwale Stop position.

(This feature works within the 1m~6m range. When the depth displayed is less than 1m, in the interests of safety it is set at 1m.)

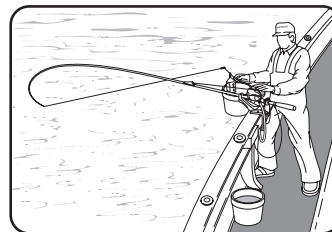

■ When set to manual

You can set your desired Gunwale Stop Position to between 1m and 6m. (Increments of 10cm)
For your safety, the Gunwale Stop Position cannot be set to less than 1m.

* The Gunwale Stop Position cannot be set when the Spool Free Mode is on. Refer to P70 for details.

Switching Between Automatically and Manually Setting the Automatic Gunwale Stop Position...

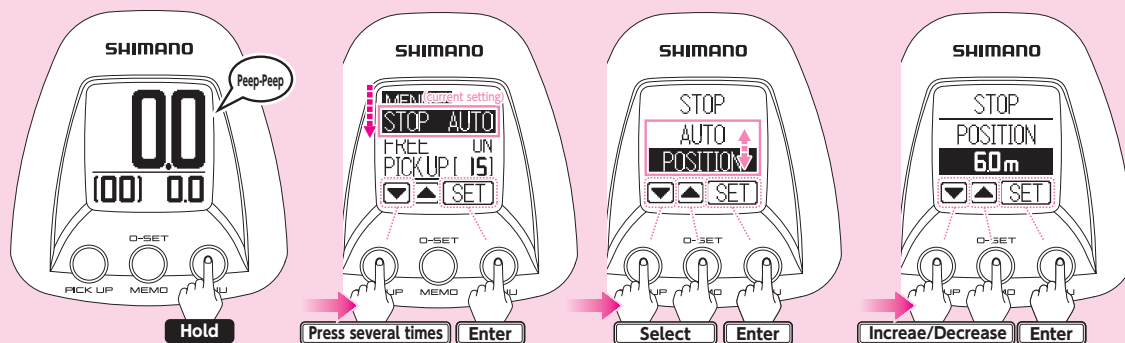

- 1** Automatic Gunwale Stop Position is set to automatic at the time of manufacturing.
From the Water Depth Display press and hold down the MENU button for more than 3 seconds and the Menu Screen will appear.

Note : Settings shown here are for instructional purposes only and may differ from actual settings.

- 2** Use the ▼ button to select STOP.
The current setting is shown to the right of the function. (Settings shown here are for instructional purposes only.) Press SET to display the gunwale stop menu.
Use the ▼▲ buttons to select POSITION, then press SET and the Automatic Gunwale Stop Position manual setting screen will be displayed.
(See P11~14 for details on operating the menu screen.)

- 3** Use the ▼▲ buttons to increase or decrease the displayed number and set the desired gunwale stop position, then press SET.

* The position can be adjusted from 1 to 6m in increments of 10cm.

Alarm (Gunwale Stop Position)

The alarm will sound to notify you when the rig is just before 4m from the Automatic Gunwale Stop Position.

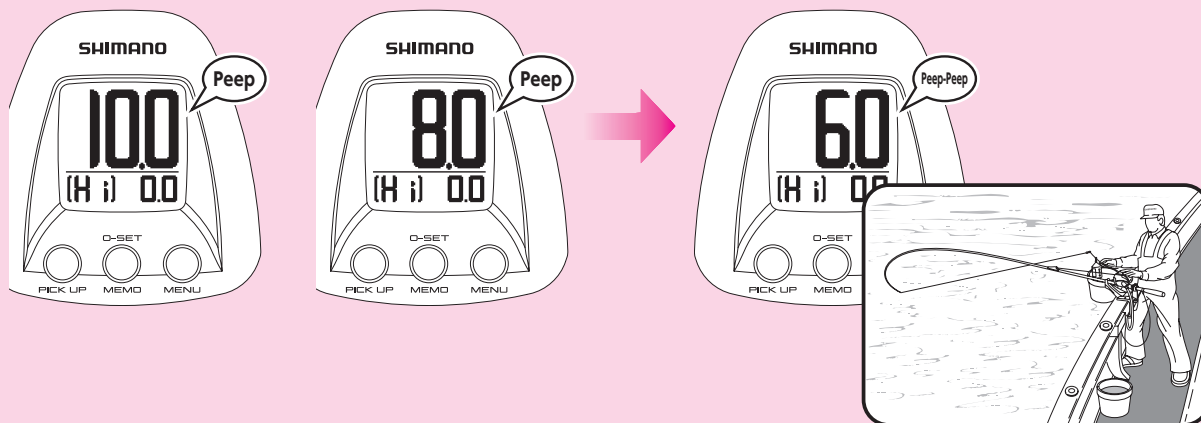

- 1** The alarm will sound every two meters once the rig has reached just before 4m from the Automatic Gunwale Stop Position.

The diagram shows the display when winding the line in with the Technical Lever on Hi.

- 2** Once the rig reaches the Automatic Gunwale Stop Position (in the example, 6.0m), the alarm will sound (peep-peep) and winding will automatically stop.

After reaching the gunwale stop position, simply tilt the rod vertically and your rig will be within hand's reach, making it possible to quickly bring it aboard like in the diagram above.

Programming Target Depth and Bottom Depth (Only when EJ Mode is OFF)



To save the water depth ...

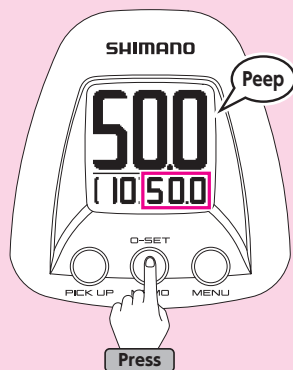

Lower the rig to the desired water depth, and then press the MEMO button.

The saved water depth will be displayed in the Saved Depth column.

(☐ section)

In the above diagram, a water depth of 50.0m has been saved.

(When Top-Down Mode is selected)

* This setting can be repeated as many times as desired.

Alarm (Depth)

The alarm will sound when the rig is 4 meters from the saved depth.



1 The alarm will sound at 2m intervals starting from 4m before the rig reaches the saved depth (only when lowering the rig).

2 The alarm will sound twice (peep-peep) when it has reached the saved depth (in this case 50.0m). The alarm will sound just once each time the rig is raised and lowered again. If the rig is wound up to within 6.0m or reset to 0, the alarm will sound again upon reaching the saved depth.

Finding the Target Depth (Only when EJ Mode is OFF)



Choose between Top-Down and Bottom-Up Modes

The secret to improving your catch is being able to accurately position your rig at the depth where the fish are.

With the latest high-performance fish finders it is possible to see the exact depth that the fish are at. The skipper of the vessel will normally give you this information.

Depending on factors such as fishing ground, fishing technique and target

species, this position may be given as the distance from the surface or the distance from the bottom.

This product lets you switch the depth display method for times when you would like to check the distance from the bottom.

Select between modes according the situation at hand.

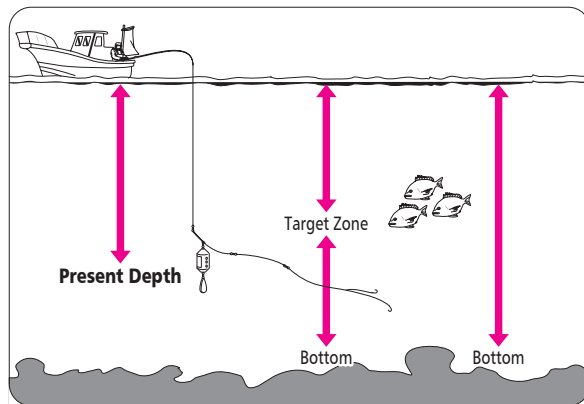

Changing Mode

1. At the Water Depth Display press and hold the MENU button for 3 seconds and the Menu Screen will appear.
2. Press ▼ several times and select TOP/BTM.

The current setting appears to the right of the function name.

(Setting shown here is for instructional purposes only.)

Press SET and the TOP/BTM menu will appear.

3. Use ▼ ▲ to choose either Top-Down or Bottom-Up, then press SET.

Please see Pages 11 ~ 14 for details regarding menu button operation.

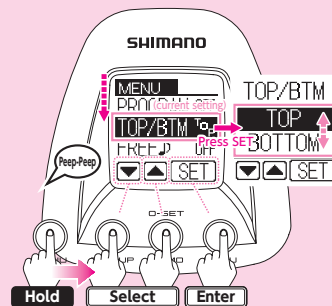

Continued on the next page. ➔

Top-Down Mode Example

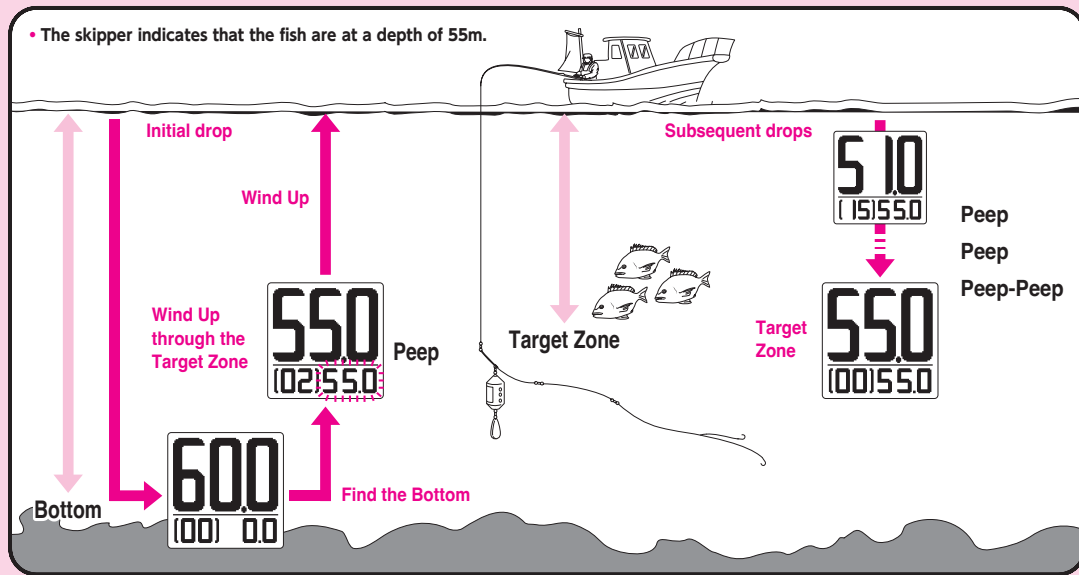

- 1** Allow the rig to drop to the bottom.
- 2** Wind the rig up to the target depth. Press **MEMO** to save the target depth.
The above procedure is used when you want to know the depth of the bottom. However, it is also possible to drop the rig to the target depth and then press Memo to save that depth.
- 3** On subsequent drops the alarm will sound when the rig reaches the saved depth.

Bottom-Up Mode Example

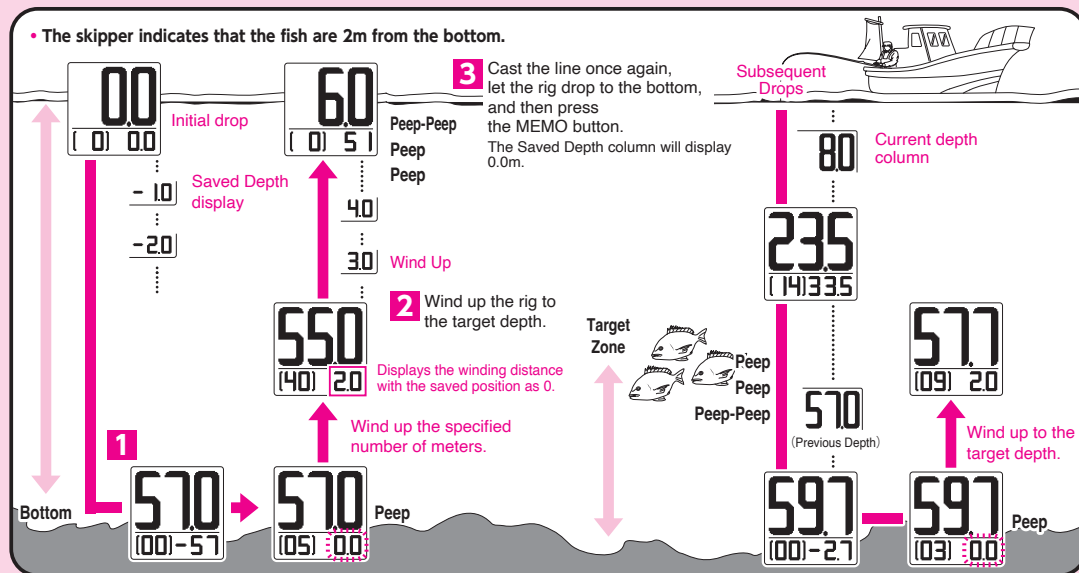

1 First lower the rig to the bottom, and then press the MEMO button.

The depth will appear in the display with the saved distance from the surface as 0. When you wind the reel, the counter will start counting upward to allow you to check the distance from the bottom.

Explanation

When the skipper says the fish are a certain number of meters from the bottom, lower the rig to the bottom and then wind it up the required number of meters. (Normally bait is scattered at this time.)

Program Mode



Replicates pro-angler reeling patterns or your own programmed technique

Particularly convenient for jerking the line continuously throughout the day when fishing for squid.

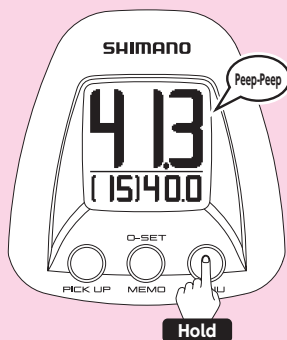

- 1 Program Mode is set to OFF when the power is turned on.
At the Water Depth Display press and hold the MENU button for 3 second and the Menu Screen will appear.

Note : All settings and values shown here are for instructional purposes only. They are not intended to be actual settings or values.

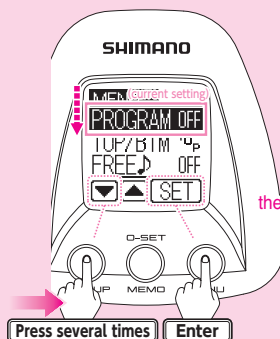

- 2 Press ▼ several times and select **PROGRAM.**

The current setting appears to the right of the function name.
(Settings shown here are for instructional purposes only.)

Press SET and the program pattern selection number screen will be displayed.

(Refer to pages 11~14 for details about how to use this menu.)

When set to ON, at the next screen you can select the program pattern number.

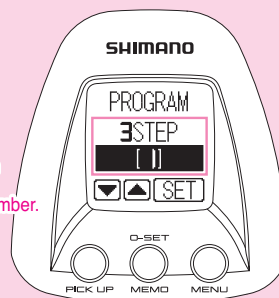

- 3 Program pattern selection number screen.

[1] to [3] are preset program patterns, [4] and [5] are custom patterns.

This product is factory-set with dead slow winding data, but your own new and custom reeling pattern can be input instead for [4] and [5].

Caution : The values and settings shown on the reel display in this manual are in some cases just examples. Actual values may differ.

[1] ... 3 STEP Mode

Winds at speed 28 of Fixed Speed Mode.

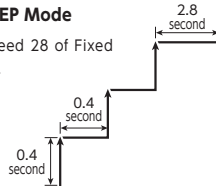

[2] ... 2 STEP Mode

Winds at speed 28 of Fixed Speed Mode.

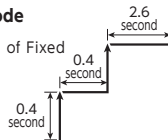

[3] ... STEP Repeat Mode

Winds at speed 16 of Fixed Speed Mode.

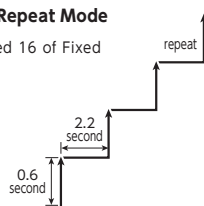

[4] • [5] ... Custom Repeat Mode



Select program

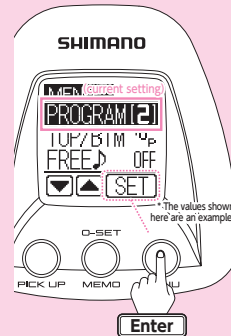

Enter

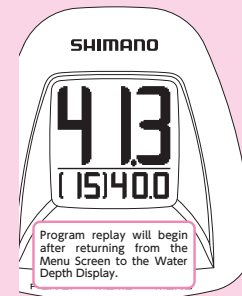

4 Use ▼▲ to select program pattern number.ct program pattern number.

* Caution

The preset program patterns are typical patterns, but the movements will depend on actual conditions such as the rod, weights, water depth, etc. If the presets do not suit the angling conditions, it is recommended that you program your own pattern and use it instead.

If you select pattern 4 or 5, proceed to the next page in this manual and follow the instructions for Program Learning.

5 Press SET to complete the setting and return to the Menu Screen.

(Illustration shows program pattern set at 2.)

Select RETURN from the Menu and return to the Water Depth Display.

The reel will then be ready to replay the programmed movement pattern.

To start the program pattern, see page 63 "Using the Program Mode"

Jigging Learning



Replicates pro-angler reeling patterns or your own programmed technique

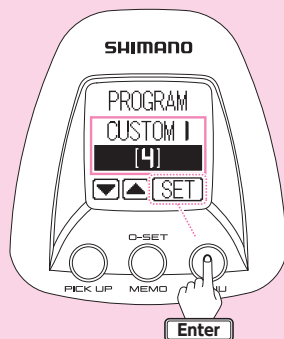

1 Choose pattern 4 or 5 and press SET.

Note : All settings and values shown here are for instructional purposes only. They are not intended to be actual settings or values.

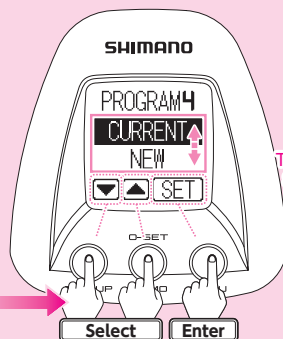

2 The next menu will appear.

To select a pattern that you have already programmed in 4 or 5, set to CURRENT, or if you want to overwrite with a new pattern, choose NEW and press SET.

When set to ON, you will return to the Menu Screen and the reel is ready for program replay.

The Program Learning Screen appears only if NEW is selected

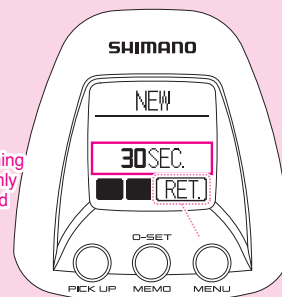

3 The Program Learning Screen only appears if NEW is selected.

Program Learning can remember a pattern up to 30 seconds long.

The number of seconds available for program memory will be displayed in . Program Learning will start as soon as winding is initiated using the Technical Lever or handle; at the same time, the number of seconds remaining in memory will count down.

To stop Program Learning, press RETURN (the MENU button).

Caution : The values and settings shown on the reel display in this manual are in some cases just examples. Actual values may differ.

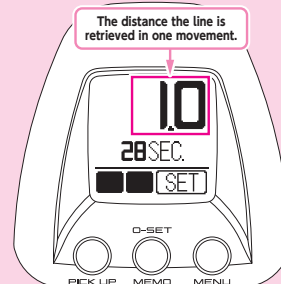
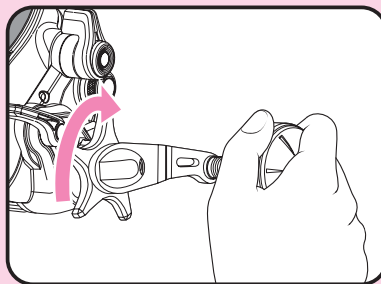
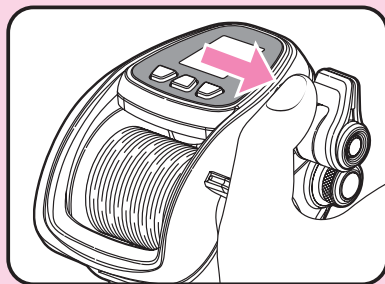

● Learning Using the Handle

Turn the handle at the desired speed and then rest for as long as you want.

If you take too long to turn the handle (more than 2 seconds for a single turn) then this will not be recorded.

If the spool turns faster than the maximum speed using the Technical Lever, then this will be recorded as the maximum speed for the Technical Lever.

● Learning Using the Technical Lever

Retrieve the line at the speed and timing you desire and then rest for as long as you want.

This is only possible in Fixed Speed Mode.

4 Review the technique (winding and rest times) recorded using the Technical Lever or the handle.

Learning starts when winding begins and at the same time the number of seconds remaining is shown on the display.

The distance the line is retrieved in one movement is shown in the center of the display.

Continued on the next page. ➡

Caution : The values and settings shown on the reel display in this manual are in some cases just examples. Actual values may differ.

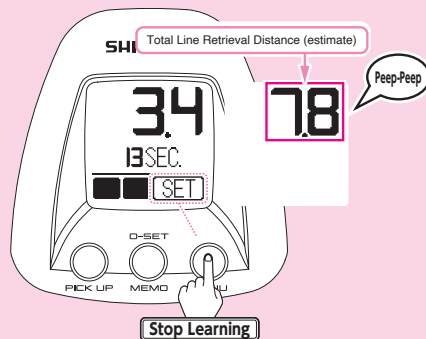

5 Press MENU to stop Learning.

If MENU is not pressed then Learning will automatically stop after 30 seconds. After Jigging Learning has stopped the total line retrieval distance (estimate) is displayed in the center of the display for 2 seconds as shown above.

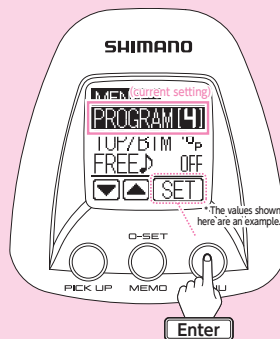

6 After 2 seconds, the display will automatically return to the Menu Screen and setting will be complete.

(Illustration shows program pattern set at 4.)

If you made a mistake or wish to re-program the pattern, re-start the Program Learning procedure from the Menu Screen.

* Entering a new pattern will delete the previous data.

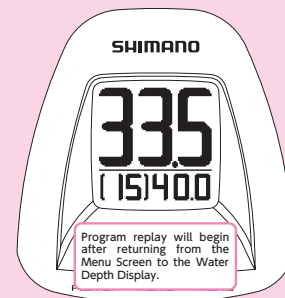

Select RETURN from the Menu and return to the Water Depth Display.

The reel will then be ready to replay the programmed movement pattern.

To start the program pattern, see the next page, "Using the Program Mode."

Using the Program Mode



Finally, try out the program pattern that you have set.

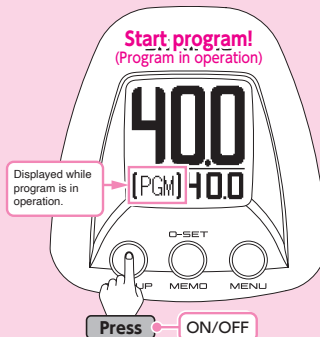
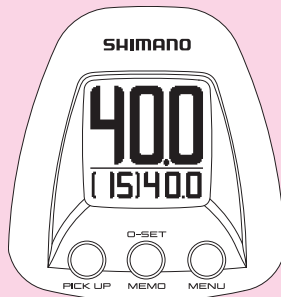

- 1 Set Program Mode to ON, referring to pages 58~62.
If the Menu Screen is displayed, select RETURN to switch to the Water Depth Display.

Note: All settings and values shown here are for instructional purposes only. They are not intended to be actual settings or values.

- 2 Lower the rig to the target depth and press the PGM button to repeatedly perform the saved program pattern.

While the program pattern is in operation, [PGM] will be displayed on the Water Depth Display.

* When Program Mode is ON, Pick Up Mode is automatically turned OFF.

To pause and restart the program pattern, press the PGM button.

* After gunwale stop, the motor stops.

Continued on the next page. ➔

Caution : The values and settings shown on the reel display in this manual are in some cases just examples. Actual values may differ.

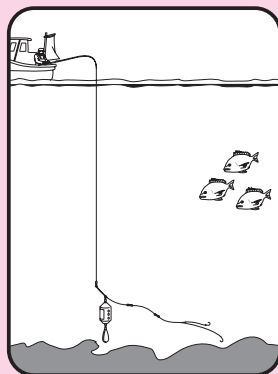

**Press the PGM button.
Program pattern starts!**

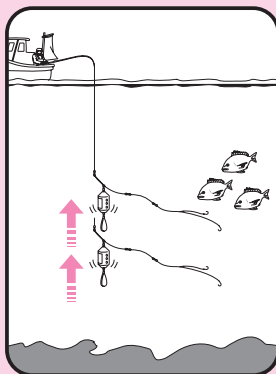

Program in operation

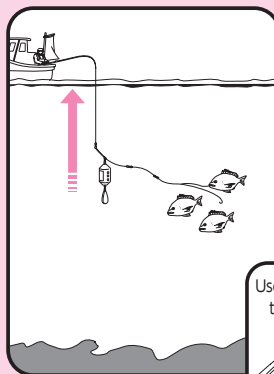

Strike! Reel in!

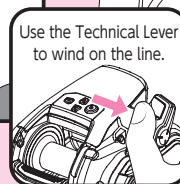

Use the Technical Lever
to wind on the line.

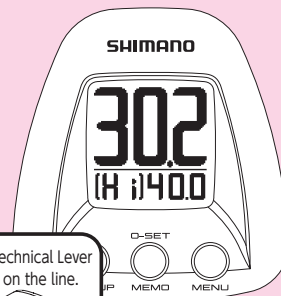

3 If there is a strike, use the Technical
Lever to reel the fish in.

With the fish landed, lower the rig and restart the program pattern again.



- 4** After rig retrieval and gunwale stop, if you want to continue with the same programmed motion, lower the rig to the target depth again.

If you want to change the pattern, set the program from the Menu Screen.

After lowering the rig, press the PGM button and the previously saved action will be repeated.

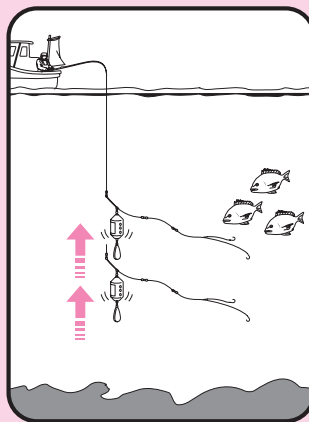

Press the PGM button.
Program pattern starts again!

Rig Retrieval Time



When retrieving the rig under power, this screen displays the time remaining for the rig to be retrieved to the Gunwale Stop Position.

Use the procedure shown below to turn ON this function.

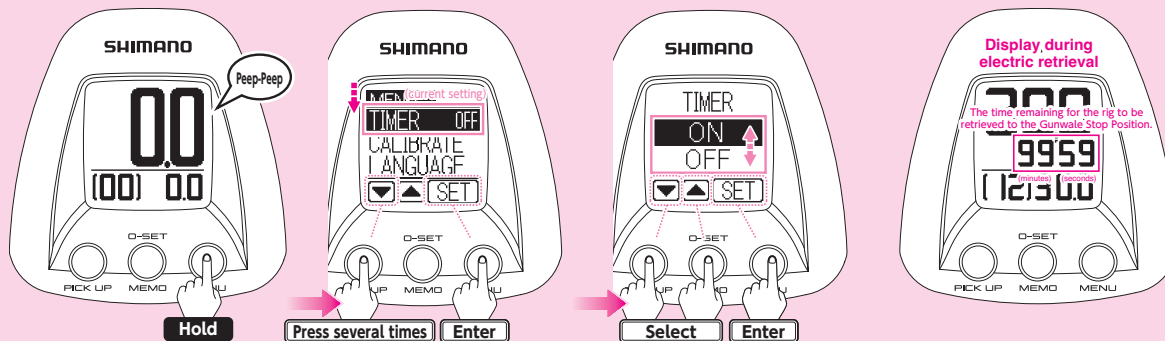

- 1** Rig retrieval time is set to off at time of manufacturing.
The illustration above shows an example of when the Water Depth Display is off. From the Water Depth Display press and hold down the MENU button in for more than 3 seconds and the Menu Screen will appear.

Note : All settings and values shown here are for instructional purposes only. They are not intended to be actual settings or values.

- 2** Press ▼ several times and select **TIMER**.
The current setting appears to the right of the function name.
(Settings shown here are for instructional purposes only.)
Press SET to display the Rig Retrieval Time menu.
Use ▼▲ to choose either ON or OFF, then press SET to complete the setting.
Please see Pages 11~14 for details regarding menu button operation.

When retrieving the rig under power, this displays the time remaining for the rig to be retrieved to the Gunwale Stop Position. The display can show a maximum of 99' 59 (99 minutes and 59 seconds). For times longer than that the display will flash 99' 59.

Spool Free Mode (Only when EJ Mode is OFF)



Prevents rig from winding up into tip and alerts you to a strike

Spool Free Mode enables two functions—the Overwinding Prevention Function and the Strike Detection Alarm.

1 Overwinding Prevention Function

When free-spool fishing or engaging in other types of low-load angling, the load varies greatly depending on whether a fish is on the line or you are simply retrieving the rig.

Winding learning on an electric reel records the number of rotations at a specific load, so that a large fluctuation in load causes a large error. When a nylon or fluorocarbon line is used together with a line with high elastic stretch, the error becomes even greater. Sometimes the rig will get wound up into the rod tip and may damage the tip.

With Spool Free Mode ON, a program runs to prevent entanglement in the tip, allowing you to relax and safely enjoy fishing. When this program detects a high load on the reel when retrieving the rig, it sets the gunwale stop position at 6m. When the detected load is light, the gunwale stop position is set at 10% of the line length that has been sent out (10m for a 100m line, or 6m at a minimum).

※ Whichever is activated, the numbers shown on the counter will become slightly off from the actual meter count. This function will turn on at a speed of 20 or higher; the rig can sometimes get entangled in the tip when winding up with light loads at speeds of less than 20.

2 Strike Detection Alarm

When the line is let out with the clutch OFF, if the line is drawn faster than the set speed, the strike alarm will beep repeatedly for 3 seconds, notifying you of a strike. You can also change the value of this setting.

The default setting is OFF.

- ※ When the motor is off, this function takes effect when the counter display is 20m or higher.
- ※ To change the set speed, on the Menu Screen turn Spool Free Mode ON and the settings screen will appear. (See next page.)

Continued on the next page. ➡

To turn Spool Free Mode ON/OFF or set the Strike Detection Alarm speed

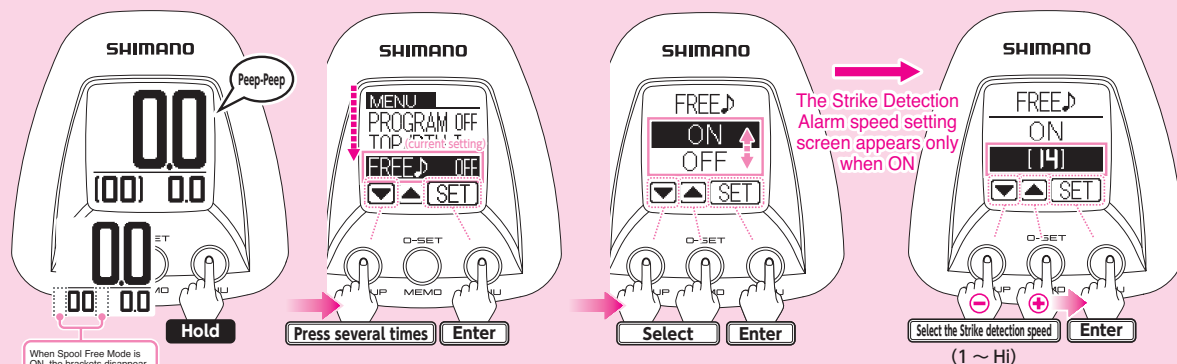

- 1 When Line Learning Mode Fluoro E2 is complete, the Spool Free Mode will be activated automatically.

*When Spool Free Mode is ON, the brackets around the Water Depth Display disappear.

At the Water Depth Display press and hold the MENU button for 3 seconds and the Menu Screen will appear.

Note : All settings and values shown here are for instructional purposes only. They are not intended to be actual settings or values.

- 2 Press ▼ several times and select FREE ↵. The current setting appears to the right of the function name.

(Settings shown here are for instructional purposes only.)

Press SET to display the FREE ↵ menu. Use ▼ ▲ to choose either ON or OFF, then press SET.

(See Pages 11 ~ 14 for details regarding Menu Screen operation.)

- 3 When set to OFF, you will return to the Menu Screen and the setting is complete.

Only when set to ON will the screen appear for setting the Strike Detection Alarm speed.

Set the Strike Detection Alarm Speed

Use ▼ ▲ to increase or decrease the speed, then press SET.

*Can be set from 1 to Hi.
(Default setting is 14.)

Line Learning Adjustment



Set the target depth more accurately by correcting the discrepancy between the depth shown on the display and the markings on the line.

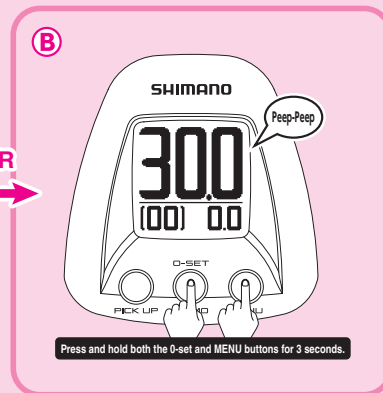
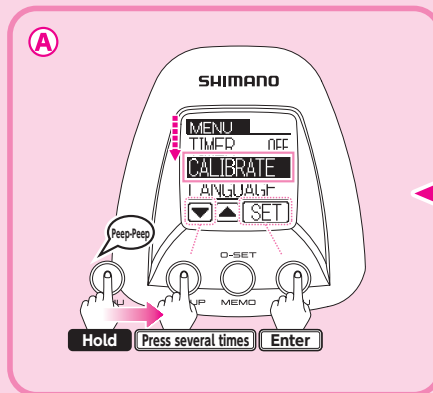
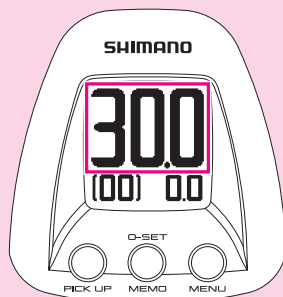

- 1 Effective at a depth of more than 10m.
Round up the present depth displayed to a convenient number (round decimal points to 0) to easily match it with the markings on the line. The color of the line changes every 10m.

*More accurate adjustment is possible at depths greater than 100m, such as when the display changes from 199m to 200m.

- 2 Enter Line Learning Adjustment using either A or B.

There are two methods for making adjustments. The same adjustments can be made using either method.

A From the Menu Screen

Press and hold the MENU button for 3 seconds and the Menu Screen will appear.

Press \blacktriangledown several times and select CALIBRATE and press SET.

(See pages 11-14 for details regarding Menu Screen operation.)

B Using the buttons

Press and hold both the 0-SET and MENU buttons for 3 seconds to enter Line Learning Adjustment.

You will hear two short beeps.

※When using this method, after calibration is completed you will return to the Water Depth Display.

Continued on the next page. →

Caution : The values and settings shown on the reel display in this manual are in some cases just examples. Actual values may differ.

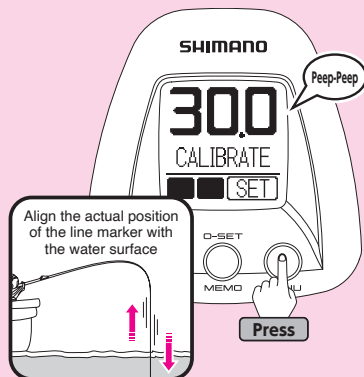

3 Adjust the display to match the actual position of the line (30m in this example) on the surface of the water.

* Using the motor (winding in the line or hooking a fish, etc.) will also cancel the adjustment. When that happens, the previous adjustment setting will be used.

Press MENU to complete the adjustment. The alarm will sound (peep-peep). The display will return to Standard Mode and the adjusted depth will be shown on the display.



A From the Menu Screen

After the calibration is complete you will return to the Menu Screen. Select RETURN on the Menu and you will return to the Water Depth Display and the calibrated water depth will be shown. Menu Screen operation.)

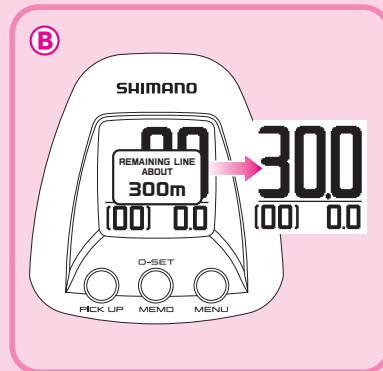

B Using the buttons

After the calibration is complete you will return to the Water Depth Display. The calibrated water depth is shown on the Current Water Depth Display. return to the Water Depth Display.

Even if the power is turned OFF, Line Learning changes will be saved.

Condition resulting in the line remaining display being shown

The line remaining display will be shown when the counter has been adjusted after using the Line Learning function.

* The amount of line remaining can also be checked from REEL DATA in the menu (see P13).

1

The depth on the display is different from the line marking!

100m

SEA

2

Use Line Learning Adjustment.

What do I do?

Press and hold the MENU button for 3 seconds to go to the Menu Screen

Hold

Select CALIBRATE from the Menu.

Select Enter

* Or from the Water Depth Display... You can also press and hold both the 0-SET and MENU buttons for 3 seconds to enter Line Learning Adjustment.

Press and hold both the 0-set and MENU buttons for 3 seconds.

3

The depth shown on the display flashes and does not change even though I am winding in and feeding out the line.

103

CALIBRATE

SET

4

Just match the markings of the line with the depth shown on the display and ...

103m

then press MENU. It will be perfectly adjusted for the next time.

Press

Handling Instructions

This reel consists of precision electrical components. Please read and follow the instructions below. Proper maintenance after every fishing trip is recommended to ensure that you will be able to enjoy using the reel for many years to come.

1 Caring for Your Reel

* Always remove the power cord, replace the power cord connector cap, and make sure that the reel has completely cooled down before you start any maintenance.

First, firmly tighten the drag. Rinse the reel with tap water, using a sponge to remove any dirt on the reel's exterior.

We have created a video showing how to wash your reel. Scan the QR code below to view it.

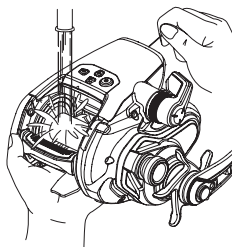

* Do not immerse the reel in water.

Disengage the clutch and let out 2-3m of line while rinsing the area between the spool and reel with water as shown in the diagram to get rid of any salt that may be adhering to the spool bearing section.

Loosen the drag completely and leave the reel to dry thoroughly in a shady place.

* Always wash with tap water or lightly brush the alligator clips to get rid of any impurities from seawater.

* Salt build-up in the bearings

Both the shields and bearings of S A-RBs (Shielded AntiRust Bearings) are made from corrosion-resistant material. However, that does not entirely prevent saltwater from entering the bearings and leaving a build-up of dried salt. They will not rust, but the rumbling sound that accompanies this build-up will sound the same as if they were rusty. The remedy for this will depend on the extent of the build-up, but you can either remove the S A-RBs and rinse them with tap water to remove the salt, or replace the S A-RBs. It is recommended that you have the S A-RBs maintained regularly.

2 Caring for Your Reel

(When you notice a deterioration in spool rotation)

● If the spool is not rotating as smoothly as usual even after normal maintenance then this may indicate that there is a build-up of salt in the bearing near the handle.

* Always remove the power cord before attempting.

1. Carefully immerse the reel in tap water up to spool as shown in the diagram. Do not immerse the whole reel. Rotate the spool to dissolve the salt and regain performance.
2. Remove the reel from the water and hold it up with the power cord connector side facing down to ensure that the water completely drains from inside the reel.
(Be sure to completely drain all water that has collected inside the reel.)

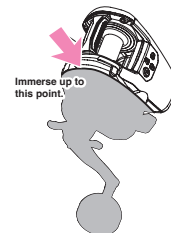

If that does not improve the situation, please contact your nearest sales office to have the reel overhauled.

3 Precautions

- One of the characteristics of powered reels is that even though the motor is ON, sometimes line will not get wound in if a fish is hooked and the drag is slipping. This is similar to an automobile driving with the parking brake on. If such a situation goes on for a long time, it can cause the grease in the drag to thermally degrade and damage to the drag. Take care not to allow this to happen as it could eventually destroy the entire reel.
- When the line is caught, do not exert excessive force on the rod or reel. Instead, please cut the line after taking care to minimize the amount of line left in the fishing ground.
- Please take care when handling the reel. Never throw it in your bag or allow it to bang against other items during transportation.
- NEVER drop or hit the reel. Treat it carefully.
- Take care not to hit the back of the reel or the power cord, or bend the power cord when putting the reel into a rod stand. Take special care not to trap the power cord between the reel and the gunwale.
- Some types of polarizing sunglasses make it difficult to properly view the display.
- After winding in a heavy load, take care when dropping the rig and winding it in the next time as the rig may get tangled with the tip of the rod.

- If the resin foot of the reel is secured to a metal reel mount, this may damage the resin and can ultimately damage the whole reel. Please make sure the resin protector is properly in place when attaching the reel to a metal mount.
- When using a reel equipped with a Super Free spool, turning the clutch to ON while the motor is ON will cause damage to the clutch. Always check that the motor is OFF before turning the clutch to ON.
- When using a reel equipped with a Super Free spool, note that when releasing line with the clutch turned to OFF, the Level Winder will not operate in tandem. When the drag is slipping, the Level Winder may not sync with the spool.
- Due to static electricity, the display may temporarily not appear properly or may appear blurred, but this will not affect functionality.

The memory backup (counter information storage) function will operate when the reel has been connected to a power source for 10 or more minutes (memory backup will last for approximately 30 minutes*).

If the reel is disconnected from a power source during use, the display will turn off, but when reconnected to a power supply, the display will return to the Water Depth Display in the state that it was in immediately prior to disconnection.

* Estimated time under normal temperature conditions (20 ~ 25 ° C). Memory backup time may be shorter in other temperature ranges.

Continued on the next page. →

Maintaining Your Reel

- **Regular Maintenance - Please contact your nearest service center.**

The condition of the reel is greatly influenced by not only frequency of use, but also the environment in which it is used, how it is used and the target species. If any abnormality is detected, please contact your nearest service center through the place of purchase immediately. A regular professional maintenance check once every six months is highly recommended.

- Always remove the power cord from the reel before storing it.
- Place the protective cap on connectors when the reel is not in use.
- NEVER try to disassemble the reel as this can damage internal electrical components such as the motor and circuit breaker and may cause the reel to malfunction.
- NEVER oil the drag mechanism as this may decrease performance.
- Leaving the reel in high temperature, high humidity conditions for a long period of time may cause deformation or weakness. Always store in a cool, dry place after carrying out regular maintenance.

- NEVER immerse the entire reel in water, especially the display. (Although the display is shower proof it is best to avoid immersing it in order to prevent any trouble.

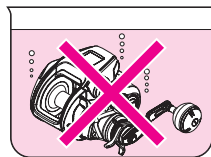

- **Removing the handle.**

1. Undo the two screws to remove the plate from the handle.
2. Undo the bolt inside the handle.

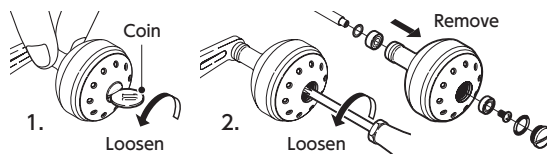

この製品について取得又は適合性確認済みの技術認証(EMC認証)

Technical certification (EMC certification) obtained or conformance verified for this product

이 제품에 대해서 취득, 또는 적합성 확인 완료 기술인증(EMC인증)

Certificaciones técnicas (de CEM) obtenidas o con las cuales se ha confirmado que cumple este producto

Certificazione tecnica (certificazione EMC) ottenuta o compatibilità verificata per questo prodotto

Teknisk certifiering (EMC-certifiering) gällande anskaffning och kompatibilitetsverifiering för denna produkt

本产品已获得或已确认了符合性的技术认证 (EMC认证)

Certifications techniques (certifications CEM) obtenues ou conformité vérifiée pour ce produit

Certificação técnica (certificação EMC) obtida ou que foi confirmada a conformidade para este produto

Für dieses Produkt erhaltene technische Zertifizierung (EMV-Zertifizierung) oder überprüfte Konformität

Получено техническое свидетельство (сертификат ЭМС) или подтверждено соответствие для данного

CE	UKCA	ACMA
○	○	○
KC		
○		

5 Safety Features

● Automatic Circuit Breaker

When the electric reel is overburdened the motor will cut out for a maximum of 2 seconds and recover automatically. This is designed to protect the reel and is not a malfunction.

If it continues in this state the automatic circuit breaker will cut out, and BREAKER will flash on the display.

When this occurs do not operate the motor and let the unit rest for at least 5 minutes to protect the motor. (In this instance the Line Learning Mode will be saved and the display counter will work normally even if the line is wound manually and the clutch disengaged.)

The breaker has been restored once the alarm sounds (beep-beep) and BREAKER no longer appears on the display.

Caution :

- While the breaker is cut out the unit cannot be restored by turning the power off and on again.
- Depending on the type of breaker, it may take from 30 seconds to 3 minutes to be restored.



● Battery Status Display

The battery icon will flash when the battery voltage drops below 10.5V or the cable connector is not connected properly. If the battery icon flashes check the cable connector is connected properly. If this is not the cause then it may be due to a low battery.



● Error in the Electric Reel

If the following error message appears, refer to the "Product Inquiries / After Sales Service Information" section, and arrange for repair.



ERROR :
Technical Lever fault

● If Voltage is Too High

The breaker will trip if voltage is too high.

Please check the power source and make sure that it provides between 12V~16.8V.



● Inaccurate Line Learning Operation

This error message indicates inaccurate Line Learning. Carry out Line Learning again.



Specifications

Practical Power

6.5kg

The winding strength that can be maintained for an extended period of time.

Practical Power is the weight of the load when the circuit breaker actually trips under the gradually increasing load.

Maximum Speed

150m/min.

Retrieval speed when winding the line in with no load.

Maximum Drag

15.0kg

Maximum drag for Shimano boat reels is the drag produced when a person pulls the reel with one hand.

Practical Speed

$\frac{1 \text{ kg (Load)}}{129 \text{ m/min.}}$	$\frac{5 \text{ kg (Load)}}{108 \text{ m/min.}}$
--	--

Retrieval speed from 100m below sea level.

Practical Speed is for example, is the speed at which a specific load can be reeled in from 100m at maximum speed using a #3000 series reel with 300m of POWER PRO 80lb.

Measuring Conditions : A 13V power supply at 15~20° C.

(Speed will be higher if a higher voltage lithium battery is used.)

* Measurements may fluctuate according to the environment in which the reel is used.

Model Number	Gear Ratio	Weight (g/oz)	PowerPro EU DIA. (mm-m)	PowerPro US (lb.-yds.)	PE (No.-m)	Fluoro (No.-m)	Winding Capacity (cm/turn : inch/turn)	Handle Length (mm)	Bearing Number (balls/roller)
3000	3.9	685 / 24.2	0.32-450 0.36-390 0.41-280 0.43-230	40-490 50-425 65-305 80-250	4-450 5-350 6-300 8-200	5-420 6-350 7-300 8-240	70:28	75	4 / 0

•Power Supply (DC Only)

DC 12V (Compatible with lithium batteries.)

•Caution

When using POWER PRO 30lb or less, take care not to cause backlash or the line may be caught between the spool and the frame.

Troubleshooting

Situation	What to do	Reference
The display is black or shows all characters.	This happens when the unit is left somewhere at high temperature, such as in a car boot. It will return to normal when the temperature goes down.	
Nothing appears on the display.	Check to see if the (+) and (-) of the power cord are connected properly to the battery. Check to see if the battery has sufficient charge. Check the surface of the alligator clips for foreign objects.	P17
Nothing appears on the display (when used in extreme cold).	When the LCD display is left in extreme cold (below -15° C), the display will not work for a while even though the power is turned on. Wait until the circuit board inside the unit warms up. When fishing in extremely cold conditions, it is recommended that the reel be kept in the cabin or under cover until it is needed.	
Line Learning cannot be set.	Please try the Line Learning process again.	P19~44
The numbers on the display do not change even when line is fed out.	Please try the Line Learning process again.	P19~44
There is too much discrepancy.	Please try the Line Learning process again.	P19~44
The number on the display does not match the line depth marks.	Depending on the type of line, sometimes the line gets stretched, which can cause discrepancies on the display.	
The Gunwale Stop position is wrong.	This is probably due to winding tension or stretched line. Carry out 0 set. Gunwale set is only possible between 1~6m. Settings between 0~1m are rounded up to 1m for safety reasons.	P46~47
The display is working but the motor is not.	Check if the battery has enough charge. When the battery does not have enough charge, the motor may work at low speed but not at high speed. Charge the battery and test the reel. If that does not improve the situation, you may need a new battery. The motor may not work when the temperature of the reel is below 0° C. When fishing in extremely cold conditions, keep the reel in the cabin or leave it ON until it is needed. Furthermore, the motor does not start when the display shows less than 1m for safety reasons.	P17

Situation	What to do	Reference
The motor stops while winding.	Make sure all the screws on the power cord connector are at the connector. If the boat' s power supply terminal or the reel' s power cord connector is rusty, the current will not flow properly. Remove any rust and try again. Battery charge should also be checked.	P17
There is a strange sound in the reel even when not winding.	A condenser is installed under the display unit to protect the reel from fluctuating current. The condenser may vibrate and make some noise when the reel is used with an unstable power supply. However, this will not affect reel function so it is OK to keep on using it.	
ERROR LINE SET AGAIN will appear on the screen.	This is an error message generated by a safety feature. Refer to the "Safety Features" page.	P17
Alphanumeric characters are displayed for two seconds when the power is turned on.	This is a display used for identification, and is not the sign of a problem. The display details vary depending on the product model.	

In order to enjoy fishing, please turn the power on and check the performance of the reel before you go.
(The motor does not come on unless the line is fed more than 1.1m.)

If above checks still do not improve the situation, please contact the retailer you purchased the reel from and explain the problem in detail.

Product Inquiries / After Sales Service Information

**Please include your telephone number when you send us an inquiry by mail.
It is easier to explain some reel mechanisms on the phone rather than in writing.**

- When the reel needs repairing, please take it to the retailer you purchased it from together with the guarantee and the power cord. We need to know detail regarding the problem. (E.g. The stopper does not work.)

A charge will be made for the necessary replacement parts and labor. We cannot compensate for damaged or lost tackle arising from a damaged Shimano product and/or fishing trip expenses.

- If you wish to order a part or replacement spool, please order from the place of purchase, specifying product name, merchandise code/product code, part name/number as shown in the component diagram. (We recommend sending in the whole reel for the repair.)

Example/

Product Name: PLAYS 3000

Product Code: 51RG821A20X

Part Number: 12

Part Name: Handle Assembly

- Shimano retains fundamental parts (i.e. the parts necessary to maintain the function of the product) for fishing rod for up to 6 years after the manufacturing of a particular model is stopped. We may not accept a request for the repair if parts are not available. Some other minor parts may not be provided even if it is less than 6 years since the manufacturing of the product has been stopped.

● Product Code

The top five digits of the product code is recorded on the instruction manual, component diagram, and bottom or side of the package.

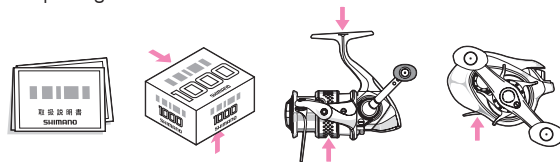

Service network

SHIMANO

SHIMANO INC.

3-77 Oimatsu-cho, Sakai-ku, Sakai City, Osaka 590-8577 Japan

SHIMANO NORTH AMERICA FISHING, INC.

9560 Palmetto Commerce Parkway Ladson, South Carolina 29456 U.S.A. Phone: +1-877-577-0600

SHIMANO CANADA LTD.

427 Pido Road Peterborough, Ontario K9J 6X7 Canada Phone: +1-705-745-3232

SHIMANO EUROPE B.V.

High Tech Campus 92, 5656 AG Eindhoven, the Netherlands Phone: +31-40-2612222

SHIMANO GERMANY FISHING GMBH

Diessemer Bruch 114F, 47805 Krefeld, Germany Phone: +49-2151-55670

SHIMANO ITALY FISHING S.R.L.

Strada Statale del Sempione 197, 20016 Pero Milano (IT), Italy Phone: +39-023-859-2096

SHIMANO NEW ZEALAND LIMITED

79 Apollo Drive, Albany, North Shore City 0632 Auckland, New Zealand Phone: +64-9-478-1969

SHIMANO UK LTD.

Unit 2, Elm Court, Copse Drive, Meriden Business Park, Coventry. CV5 9RN, United Kingdom
Phone: +44-330-333-4888

SHIMANO AUSTRALIA FISHING PTY. LTD.

2 Wurrook Circuit, Caringbah, NSW, 2229, Australia Phone: +61-2-9533-0000

SHIMANO (SHANGHAI) SALES CORPORATION

Room 201-203, IM Shanghai T1, No. 1388 Kai Xuan Road, Changning District, Shanghai 200052, China Phone: +86-21-52061212

SHIMANO POLSKA SP. Z O.O.

Ul. Jana Gutenberga, 62-023 Żerniki, Poland Phone: +48-61-6252-120

SHIMANO (SINGAPORE) PTE. LTD.

11 Bulim Walk, Singapore 648105 Phone: +65-6265-4777





此标记表示环保使用期限，其遵循以下标准：
SJ/T 11364-2014 电子电气产品有害物质限制使用标识要求
SJ/Z 11388-2009 电子信息产品环保使用期限通则

部件名称 (Parts name)	有害物质 (Hazardous substances)					
	铅 Pb	汞 Hg	镉 Cd	六价铬 Cr VI	多溴联苯 PBB	多溴二苯醚 PBDE
印刷电路板 (PCBA)	×	○	×	○	○	○
电线 (cable)	×	○	○	○	○	○
外壳 (case)	×	○	○	○	○	○
金属部件 (metal parts)	×	○	○	○	○	○

本表格依据 SJ/T 11364-2014 的规定编制。

○：表示该有害物质在该部件所有均质材料中的含量均在 GB/T 26572 规定的限量要求以下。

×：表明该有害物质至少在部件的某一均质材料中的含量超出 GB/T 26572 规定的限量要求。

然而，具有 × 的所有部件都符合 EU RoHS 指令 2011/65/EU 的要求。

All parts are compliant with European RoHS (2011/65/EU) requirements.

Toutes les pièces sont conformes aux exigences de la Directive européenne RoHS (2011/65/UE)

The Shimano logo is centered in the upper half of the page. It consists of the word "SHIMANO" in a bold, magenta, sans-serif font. The logo is positioned between two horizontal bands of color: a light pink band above and a darker pink band below. The entire page is framed by a light gray border with registration marks at the corners and midpoints.

SHIMANO

• Line Threading Pin

(250114)